



KICKPLATES

2

TRIMCO KICKPLATES

Solid Brass



16 gauge kickplates, eased edges drilled and furnished with stainless steel wood screws, plated to match plate. Individually paper wrapped.

Code	Size	Finish	List/ea
K0050-605-628	6" x 28"	Pol. Brass	\$ 88.27
K0050-605-630	6" x 30"	Pol. Brass	54.31
K0050-605-634	6" x 34"	Pol. Brass	61.50
K0050-605-828	8" x 28"	Pol. Brass	75.50
K0050-613-828	8" x 28"	Oil R. Bronze	76.33
K0050-630-828	8" x 28"	Dull St. Steel	26.11
K0050-605-830	8" x 30"	Pol. Brass	71.35
K0050-613-830	8" x 30"	Oil R. Bronze	77.89
K0050-630-830	8" x 30"	Dull St. Steel	31.40
K0050-605-834	8" x 34"	Pol Brass	78.27
K0050-613-834	8" x 34"	Oil R. Bronze	95.97
K0050-630-834	8" x 34"	Dull St. Steel	38.49
K0050-605-840	8" x 40"	Pol. Brass	92.10
K0050-613-840	8" x 40"	Oil R. Bronze	160.81
K0050-605-1028	10" x 28"	Pol. Brass	66.05
K0050-613-1028	10" x 28"	Oil R. Bronze	95.86
K0050-630-1028	10" x 28"	Dull St. Steel	34.10
K0050-605-1030	10" x 30"	Pol. Brass	86.50
K0050-613-1030	10" x 30"	Oil R. Bronze	101.86
K0050-630-1030	10" x 30"	Dull St. Steel	34.97

TRIMCO KICKPLATES Cont.

Code	Size	Finish	List/ea
K0050-605-1034	10" x 34"	Pol. Brass	\$ 96.97
K0050-613-1034	10" x 34"	Oil R. Bronze	119.98
K0050-630-1034	10" x 34"	Dull St. Steel	42.36
K0050-605-1040	10" x 40"	Pol. Brass	115.11
K0050-613-1040	10" x 40"	Oil R. Bronze	141.25
K0050-630-1040	10" x 40"	Dull St. Steel	54.20

BALDWIN LIFETIME FINISH KICKPLATES

Solid Brass, Polished Brass Lifetime Finish



Code	Size	List/ea
2001-003-0630	6" x 30"	\$ 87.96
2001-003-0634	6" x 34"	101.10
2001-003-0834	8" x 34"	112.22

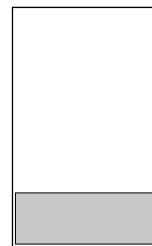

Kick
Plate

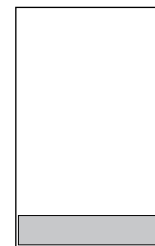

Mop
Plate

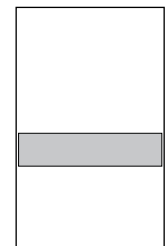

Stretcher
Plate



PUSH & PULL PLATES

TRIMCO PULL PLATES

2

Solid Brass



No.	Size
1010-2	3.5" x 15"
1010-3	4" x 16"

Solid Brass Pull Plates. .050 Gauge. One ea/ Ctn.
C/C of pull: 5"

Code	Size	Finish	List/ea
1010-2-605	3.5" x 15"	Pol. Brass	\$ 77.89
1010-2-613	3.5" x 15"	Oil R. Bronze	50.63
1010-2-619	3.5" x 15"	Satin Nickel	93.54
1010-2-626	3.5" x 15"	Dull Chrome	84.92
1010-2-628	3.5" x 15"	Dull Aluminum	19.21
1010-3-605	4" x 16"	Pol. Brass	82.60
1010-3-613	4" x 16"	Oil R. Bronze	89.45
1010-3-626	4" x 16"	Dull Chrome	89.26

TRIMCO PUSH PLATES

Solid Brass



No.	Size
1001-1	3" x 12"
1001-2	3.5" x 15"
1001-3	4" x 16"

Solid Brass Push Plates. .050 Gauge. One ea/ Ctn.

Code	Size	Finish	List/ea
1001-1-605	3" x 12"	Pol. Brass	\$ 25.11
1001-1-613	3" x 12"	Oil R. Bronze	25.39
1001-1-619	3" x 12"	Sat. Nickel	30.24
1001-1-626	3" x 12"	Dull Chrome	25.30
1001-1-630	3" x 12"	Dull Stainless Stl	11.40
1001-2-605	3.5" x 15"	Pol. Brass	22.24
1001-2-613	3.5" x 15"	Oil R. Bronze	25.34
1001-2-619	3.5" x 15"	Sat. Nickel	33.40
1001-2-626	3.5" x 15"	Dull Chrome	30.44
1001-2-630	3.5" x 15"	Dull Stainless Stl	11.02
1001-3-605	4" x 16"	Pol. Brass	25.28
1001-3-613	4" x 16"	Oil R. Bronze	30.08
1001-3-619	4" x 16"	Sat. Nickel	33.60
1001-3-626	4" x 16"	Dull Chrome	30.30
1001-3-628	4" x 16"	Satin Aluminum	10.61



LEVER DOOR STOPS

2

BALDWIN LEVER TYPE DOOR HOLDER

Forged Brass

4100 - Length of Arm: 4"

4105 - Length of Arm: 5"

Stainless steel hinging pin, holder can be operated by foot. Spring catch holds lever upright. 10/box, with wood screws.



<u>Code</u>	<u>Finish</u>	<u>List/ea</u>
4100-102	Oil R. Bronze	\$ 27.30
4100-150	Satin Nickel	27.30
4100-264	Dull Chrome	27.30
4105-030	Polished Brass	29.36
4105-102	Oil R. Bronze	29.32
4105-264	Dull Chrome	29.32

Gray Rubber Replacement Tips

For Baldwin 4100 and 4105.



<u>Code</u>	<u>Ctn</u>	<u>List/ea</u>
4101	10/box	\$ 6.07

TRIMCO LEVER TYPE DOOR HOLDER

Polished Brass

Base: 1-3/8" x 2"

Projection: 4-1/2"

Floor Clearance: 2"



<u>Code</u>	<u>Finish</u>	<u>List/ea</u>
1221-4FF-605	Polished Brass	\$ 30.94

IVES LEVER TYPE DOOR HOLDER

Solid cast aluminum



Lever projects 4".

Pack: 15/ Ctn.

<u>Code</u>	<u>Finish</u>	<u>List/ea</u>
SP455A3	Bright Brass	\$ 6.37
SP455A5	Ant. Brass	10.33
SP455A92	Nat. Aluminum	6.59

Replacement Tips for Ives SP455:



<u>Code</u>	<u>Ctn</u>	<u>List/ea</u>
CHRT4	100 ea.	\$.89



WALL DOOR STOPS

BALDWIN WALL TYPE DOOR STOP



Solid forged brass construction. Stem of bumper has hexagon shape for easy fastening without damaging finish. Resilient rubber tip is replaceable. Supplied with wood screws.

Projection: 3"

<u>Code</u>	<u>Finish</u>	<u>List/ea</u>
4045-003	Lifetime Pol. Brass	\$ 20.22
4045-030	Polished Brass	15.17
4045-050	Sat. Brass/Black	15.17
4045-102	Oil R. Bronze	15.17
4045-112	Venetian Bronze	15.17
4045-150	Satin Nickel	15.17
4045-151	Antique Nickel	15.17
4045-260	Polished Chrome	15.17
4045-264	Dull Chrome	15.17

Projection: 3.75"

4050-030	Polished Brass	\$ 20.22
4050-102	Oil R. Bronze	15.17
4050-150	Satin Nickel	15.17
4050-151	Antique Nickel	15.17
4050-260	Polished Chrome	15.17
4050-264	Dull Chrome	15.17

Projection: 3.4"



<u>Code</u>	<u>Finish</u>	<u>List/ea</u>
4055-030	Polished Brass	\$ 15.17
4055-102	Oil R. Bronze	15.17
4055-260	Polished Chrome	15.17
4055-264	Dull Chrome	15.17

REPLACEMENT TIPS FOR BALDWIN DOOR STOPS

For 4045 and 4050



4041

<u>Code</u>	<u>Ctn</u>	<u>List/ea</u>
4041	10 ea.	\$ 5.56

IDH RIGID DOOR STOP

13010

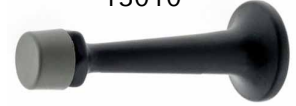

Base Dia: 1-1/4", Proj. 3".
Packed with an extra tip.

<u>Code</u>	<u>Finish</u>	<u>List/ea</u>
13010-003	Pol. Brass	\$ 7.58
13010-015	Satin Nickel	9.05
13010-019	Matte Black	11.99
13010-026	Pol. Chrome	9.05
13010-10B	Oil R Bronze	9.05
13010-26D	Satin Chrome	9.05

ERIC MORRIS RIGID DOOR STOP

Solid Forged Brass
Length: 3", Base Dia: 1-1/8"
Replacement Tip: 2349
(Special Order).

2340



<u>Code</u>	<u>Finish</u>	<u>List/ea</u>
2340-605	Pol Brass	\$ 19.90
2340-613	Oil R. Bronze	19.90
2340-619	Sat. Nickel	19.90

STANLEY WALL TYPE DOOR STOP



Solid Brass screw-on Wall Type Door Stop. Proj: 3"
Carded, 1 ea/card, with screws. Hex stem under bumper for easy installation.

<u>Code</u>	<u>Ctn</u>	<u>List/cd</u>
CD80-4015	5 cards	\$ 10.12

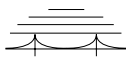

DOOR STOPS

2

IVES RIGID DOOR STOP



60 - 3.75" Proj.
61 - 3" Proj.

Cast door stop with slip over rubber bumper. With integral screw.

Code	Finish	Proj.	Ctn	List/ea
60A3	Pol. Brass	3.75"	20 ea.	\$ 2.93
60A92	Aluminum	3.75"	20	2.93
SP61A3	Pol. Brass	3"	25	2.93
SP61A5	Ant. Brass	3"	25	2.94
SP61A92	Aluminum	3"	25	2.93
61AW	White	3"	10	3.35

Solid Brass:

61MB10B*	Oil R Bronze	3"	10	\$ 13.55
----------	--------------	----	----	----------

* Disc. when out

IVES FLEXIBLE DOOR STOP

SP061



"Quick-Stall" Flexible door stop. For use in locations where a standard door stop creates problems. Projection: 4". Base Dia: 1", Tip Dia: 9/16". Packed with screws.

Code	Finish	Ctn	List/ea
SP061F3	Pol. Brass	25 ea.	\$ 1.41
SP061F5	Ant. Brass	25	1.13
SP061F14	Brt. Nickel	25	1.13

SP060



Spring steel flexible door stop with slip over rubber bumper & integral screw. Projection: 3". Base Dia: 1", Tip Dia: 5/8".

Code	Finish	Ctn	List/ea
SP060F3	Pol. Brass	50 ea.	\$.94
SP060F5	Ant. Brass	50	1.05
SP060F10B	Oil R. Bronze	50	1.05
SP060F14	Brt. Nickel	50	1.14

IVES HINGE PIN DOOR STOPS



SP69F



SP70A

Designed to fit most standard hinge pins and to allow the door to open fully without the knob hitting the wall. Adjustable.

Code	Finish	Ctn	List/ea
SP69F5	Antique Brass	25 ea.	\$ 3.64
SP69F3	Polished Brass	25	3.64
SP69F10	Bronze	25	3.64
SP69F14	Bright Nickel	25	3.64
SP69F10B	Oil R. Bronze	25	3.66
SP70A92	Nat. Aluminum	25	1.82
SP70A3	Bright Brass	25	1.89
SP70A5	Antique Brass	25	2.23
70AW	White	20	2.73

REPLACEMENT TIPS FOR IVES:

60, 61, 62, 062, 70, 430

Off white color.



CRT6

Code	Ctn	List/ea
CRT6	10 ea.	\$.52

BOMMER COAT & HAT HOOK WITH DOOR STOP

Projection: 3-3/4". Wrought brass hook with dull chrome finish. 1/box.



5030

Code	Finish	List/ea
5030-626	Dull Chrome	\$ 60.37



WALL DOOR STOPS

2

ERIC MORRIS WALL TYPE DOOR STOP

Solid Forged Brass.
Commercial Grade.



Base Dia: 2.25", Projection 3.50". Packed 5/box with wood and machine screws and expansion shields.
Replacement Rubber: 2359 (Special Order).

Code	Finish	List/ea
2353-605	Pol. Brass	\$ 58.54
2353-613	Oil R. Bronze	58.54
2353-619	Satin Nickel	58.54

IDH WALL DOOR STOP

Solid Brass
Base: 2-1/2"
Projection: 3-3/4"



Packed with fasteners.

Code	Finish	List/ea
13018-10B	Oil R. Bronze	\$ 33.36
13018-26D	Brushed Chrome	33.36

TRIMCO WALL DOOR STOP

Solid Brass
Base: 2-1/4"
Projection: 3-1/2"



Pack: 10 per box with wood screws.

Code	Finish	List/ea
1204-613	Oil R. Bronze	\$ 30.23
1204-626	Satin Chrome	24.95

WALL TYPE DOOR STOP WITH HOLDER

Eric Morris

Solid Forged Brass.
Commercial Grade.



Base Dia: 2.25", Projection 3.5". Packed 5/box with wood and machine screws and expansion shields.
Replacement Rubber: 2359 (Special Order).

Code	Finish	List/ea
2354-605	Pol. Brass	\$ 65.65
2354-613	Oil R. Bronze	65.65
2354-619	Satin Nickel	65.65

WALL TYPE DOOR STOP WITH HOLDER

IDH

Solid Brass.
Base Dia: 2-1/4"
Height: 4"
Proj. 3-1/2"



Packed with fasteners.

Code	Finish	List/ea
13016-10B	Oil R. Bronze	\$ 39.43
13016-26D	Brushed Chrome	35.39

TRIMCO WALL TYPE DOOR STOP HOLDER

Solid Brass. Base: 2-1/4", Proj. 3-3/4",
Eye: 7/8 x 2-1/4", Hook: 2-3/4"



Pack: 10 per box with wood screws.

Code	Finish	List/ea
1206-613	Oil R. Bronze	\$ 45.40
1206-626	Satin Chrome	32.49

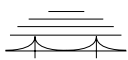

FLOOR DOOR STOPS

TRIMCO FLOOR TYPE DOOR STOP

Solid Brass. Height: 3", Base: 2-1/4".
Pack: 10 per box with fasteners for wood, concrete or plaster.

1201



Code	Finish	List/ea
1201-605	Pol Brass	\$ 35.41
1201-613	Oil R. Bronze	36.01
1201-626	Satin Chrome	23.19

IDH FLOOR TYPE DOOR STOP

Solid Brass. Base: 2-1/2",
Height: 3-1/8", Clearance: 2-3/4"
Packed with fasteners.

13022



Code	Finish	List/ea
13022-10B	Oil R. Bronze	\$ 33.36
13022-26D	Brushed Chrome	33.36

FLOOR DOOR BUMPER

Eric Morris

2320



Forged Brass const. Height: 2.625"
Packed with wood and machine screws,
plastic plug and lead anchor.

Code	Finish	List/ea
2320-619	Satin Nickel	\$ 39.00
2320-620*	Antique Nickel	39.00

* Special order when out

IVES ANGLE FLOOR DOOR STOP

Floor mounted stop to fit most
interior doors without thresholds.
Base: 1-1/4" dia. Ht: 1-5/16".
25 per box.



SP430

Code	Finish	List/ea
SP430A3	Polished Brass	\$ 2.12
SP430A5	Antique Brass	2.34
SP430A92	Aluminum	2.12

BALDWIN FLOOR DOOR BUMPERS



4510

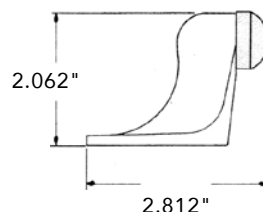

Solid forged brass door bumpers are designed for use on doors with or without thresholds. 1 per carton with wood screws.

Code	Finish	List/ea
4510-030	Polished Brass	\$ 30.33
4510-102	Oil R. Bronze	30.33
4510-260	Polished Chrome	30.33
4510-264	Dull Chrome	30.33
4510-150	Satin Nickel	30.33

TRIMCO FLOOR TYPE DOOR STOP & HOLDER

Solid Brass
Base: 2-1/4"
Height: 3-5/8"
Eye: 7/8" x 1-1/2", Hook: 2-3/4"

1223



Pack: 10 per box with wood screws.

Code	Finish	List/ea
1223-613	Oil R. Bronze	\$ 50.59
1223-626	Satin Chrome	47.46

IDH FLOOR TYPE DOOR STOP & HOLDER

Solid Brass.
Base Dia: 2-1/4"
Height: 4"
Clearance: 3-1/4"

13020



Packed with fasteners.

Code	Finish	List/ea
13020-10B	Oil R. Bronze	\$ 39.43
13020-26D	Brushed Chrome	35.39



FLOOR DOOR STOPS

2

ROUND FLOOR BUMPER

Eric Morris

Solid Brass with concealed screw mounting. Stops door from any angle. Dia: 1.185", Height to Rubber: .875", Overall Ht: 1.5". Replacement Rubber: 2326 (Special Order).



2325

Pack: 5 per box with fasteners.

Code	Finish	List/ea
2325-605	Pol. Brass	\$ 28.81
2325-613	Oil R. Bronze	28.81
2325-619	Satin Nickel	28.81

UNIVERSAL ROUND FLOOR BUMPER

Baldwin

4505

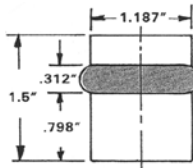

Solid Brass with concealed screw mounting. Overall Ht: 1.5", Dia: 1-3/16". Polybagged 10 ea/box with a wood screw and plastic anchor.

Code	Finish	List/ea
4505-030	Polished Brass	\$ 24.26
4505-102	Oil R. Bronze	24.26
4505-150	Satin Nickel	24.26
4505-260	Polished Chrome	24.26
4505-264	Dull Chrome	24.26

DOOR STOP & HOLDER

Sugatsune



Magnetic

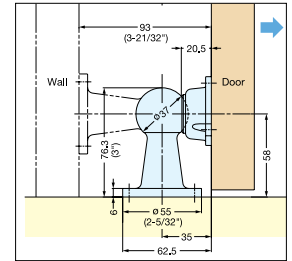

Holds door in opened position with strong magnet. Can be mounted on floor or wall. ABS and polycarbonate. Magnetic Force: 30.8 lbs.

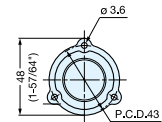

Code	Color	Ctn	List/ea
SMDH/IVY	Ivory	100	\$ 9.10
SMDH/BRN	Brown	100	9.10



DOOR STOPS

BALDWIN DOME TYPE DOOR BUMPERS

Solid Brass



Catalog Number	Height	Dia.	Base Height	For use w/ Threshold
4000	1" (25mm)	2" (51mm)	.187" (5mm)	---
4005	1.25" (32mm)	1.875" (48mm)	.375" (10mm)	.375 high (10mm)
4010	1.375" (35mm)	1.875" (48mm)	.5" (13mm)	.5" (13mm)

Packed with wood screws.

Code	Finish	Ctn	List/ea
4000-030	Polished Brass	50 ea.	\$ 13.14
4000-003	Lifetime Pol. Brass	50	8.90
4000-050	Satin Brass/Black	50	13.14
4000-102	Oil R. Bronze	50	13.14
4000-112	Venetian Bronze	50	13.14
4000-150	Satin Nickel	50	13.14
4000-260	Polished Chrome	50	13.14
4000-264	Dull Chrome	50	13.14
4005-030	Polished Brass	10	13.14
4005-102	Oil R. Bronze	10	13.14
4005-150	Satin Nickel	10	13.14
4005-260	Polished Chrome	10	13.14
4005-264	Dull Chrome	10	13.14
4010-030	Polished Brass	40	13.14
4010-102	Oil R. Bronze	40	13.14
4010-150	Sat. Nickel	40	13.14
4010-260	Polished Chrome	40	13.14
4010-264	Dull Chrome	40	13.14

RISER FOR BALDWIN DOOR BUMPER

4207: 1/2" Ht.
4209: 3/4" Ht.

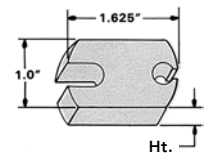

Made expressly for use on carpeted floors.
Fits Baldwin No. 4000 bumper (see opposite column).
25/box.

Code	Height	Finish	List/ea
4207-264	1/2"	Dull Chrome	\$ 17.19
4207-030	1/2"	Pol. Brass	10.11
4207-102	1/2"	Oil R. Bronze	10.11
4209-030	3/4"	Pol. Brass	12.13
4209-102	3/4"	Oil R. Bronze	12.13

ERIC MORRIS DOME TYPE DOOR BUMPERS

Solid Brass



#2312 - Low

Overall Ht: 1"
Base Ht: .115"
Base Dia: 1.85"

#2313 - High

Overall Ht: 1.3"
Base Ht: .40"
Base Dia: 1.85"

Forged Brass Dome Stops with half dome design.
Replacement Rubber: 2314 (Special Order).

Pack: Polybagged 10/box with fasteners.

Code	Overall Ht.	Finish	List/ea
2312-605	1"	Pol. Brass	\$ 16.18
2312-613	1"	Oil R. Bronze	16.18
2312-619	1"	Sat. Nickel	16.18
2313-605	1.30"	Pol. Brass	\$ 17.00
2313-613	1.30"	Oil R. Bronze	17.00
2313-619	1.30"	Sat. Nickel	17.00



DOOR STOPS

DELTA DOME TYPE DOOR BUMPERS

Solid Brass



DSLP316

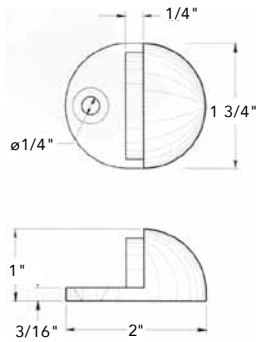

Low Profile: Requires a minimum of 3/16" of clearance between the floor and the bottom of the door. Base: 1-3/4" x 2". Base Ht: 3/16". Total Ht: 1". Screws included.

Code	Finish	Ctn	List/ea
D SLP316U3	Polished Brass	10 ea.	\$ 6.57
D SLP316U15	Satin Nickel	10	8.06
D SLP316U10B	Oil R. Bronze	10	8.66



DSHP916

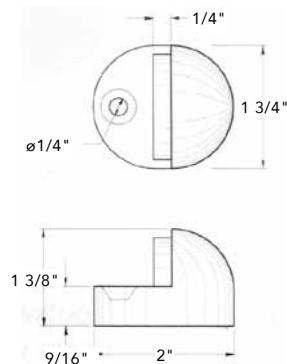

High Profile: Requires a minimum of 9/16" of clearance between the floor and the bottom of the door. Base: 1-3/4" x 2". Base Ht: 9/16". Total Ht: 1-3/8". Screws included.

Code	Finish	Ctn	List/ea
D SHP916U15	Satin Nickel	10 ea.	\$ 9.60
D SHP916U10B	Oil R. Bronze	10	10.59
D SHP916U26D	Brushed Chrome	10	10.56

IDH DOME TYPE DOOR BUMPERS

Solid Brass

13060



Low Profile. Base Height: 1/8". Overall Height: 1". Base Diameter: 1-11/16". Packed with replacement black rubber bumper and fasteners.

Code	Finish	Ctn	List/ea
13060-003	Polished Brass	10 ea.	\$ 6.98
13060-015	Satin Nickel	10	7.99
13060-10B	Oil R. Bronze	10	7.99

IVES DOME TYPE DOOR BUMPER

436B



Cast brass door bumper for doors without a threshold. Gray non-marring rubber bumper. Base: 1-3/4" W x 2" L. Height: 1". Packed with fasteners.

Code	Finish	Ctn	List/ea
436B3	Pol. Brass	10 ea.	\$ 5.57
436B26	Pol. Chrome	10	5.26
436B26D	Sat. Chrome	10	5.26
436B10B	Oil R. Bronze	10	5.31

IVES RISER

Converts #436 door stop to carpet installation.

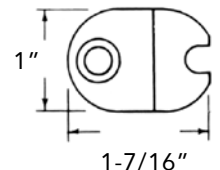

Height: 1/2". Aluminum. Packed with fasteners.

Code	Description	Ctn	List/ea
435A-12	Riser for door stop	20 ea.	\$ 5.27

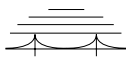

DOOR STOPS

BALDWIN MODERN CONVEX DESIGN WALL BUMPER



4252

Outside Dia: 1.75"
Projection: 1"

Heavy wall bumper of brass and aluminum with rubber insert. Compact design is less obtrusive, blends with modern screwless appearance. 10 per box.

<u>Code</u>	<u>Finish</u>	<u>List/ea</u>
4252-030	Polished Brass	\$ 12.13
4252-102	Oil R. Bronze	12.13
4252-260	Polished Chrome	12.13
4252-264	Dull Chrome	12.13

BALDWIN MODERN CONCAVE DESIGN WALL BUMPER

In addition to the properties of the 4252 shown above, this concave bumper permits knob of button-type lock to strike bumper without engaging lock mechanism.



4273

Outside Dia: 1.75"
Projection: 1"



4293

Outside Dia: 2.375"
Projection: 1"

Outside Dia: 1.75"

<u>Code</u>	<u>Finish</u>	<u>Ctn</u>	<u>List/ea</u>
4273-030	Polished Brass	50	\$ 12.13
4273-102	Oil R. Bronze	50	12.13
4273-260*	Polished Chrome	50	12.13
4273-264	Dull Chrome	50	12.13

Outside Dia: 2.375"

<u>Code</u>	<u>Finish</u>	<u>Ctn</u>	<u>List/ea</u>
4293-030	Polished Brass	25	\$ 12.13
4293-102	Oil R. Bronze	25	12.13
4293-264	Dull Chrome	25	12.13

* Special order when out

IVES WALL TYPE DOOR BUMPER



411RW

Outside Diameter: 1.75"
Projection: 1"
All rubber with adhesive back.

<u>Code</u>	<u>Color</u>	<u>Ctn</u>	<u>List/ea</u>
411RW	White	20	\$ 2.39

IVES WALL DOOR STOP



407B

Solid Brass.
Dia: 2-7/16", Proj: 15/16"
Concealed screws, plastic drywall anchor. 10 per box.

<u>Code</u>	<u>Finish</u>	<u>List/ea</u>
407B10B	Oil R. Bronze	\$ 4.68
407B26D	Dull Chrome	4.69

BALDWIN WALL TYPE FLUSH BUMPERS



4015

Dia: 1"
Proj: .562"

A small size bumper for protection of walls where doors would strike them. Rubber center. 10 per box.

<u>Code</u>	<u>Finish</u>	<u>List/ea</u>
4015-030	Polished Brass	\$ 12.13
4015-264	Dull Chrome	12.13
4015-260	Polished Chrome	12.13
4015-102	Oil R. Bronze	12.13



ELECTRIC DOOR OPENERS

TRINE ELECTRIC DOOR OPENERS

2



001



004



005

Designed for remote control of door locks for apartment buildings, businesses, public buildings, and anywhere security is required. Operate on 8 to 16 volts AC or 3 to 6 volts DC. Other voltages special order. US 4 Finish.

Model 001: For mortise bolt locks with latch bolt only. Reversible for LH or RH doors.
Face: 5-7/8" x 1-1/4" x 1-9/16" deep.

001 US 4 Finish List \$ 51.83 ea.

Model 004: For mortise bolt locks having a deadbolt and latch bolt. Opener operates latchbolt strike. Reversible for LH or RH doors.
Face: 6-1/4" x 1-3/8". Case 1-7/8" x 2-3/4" x 1".
1 per box.

004 US 4 Finish List \$ 99.84 ea.

Model 005: For mortise bolt or regular key-in-handle sets. Reversible for LH or RH doors.
Face: 3-1/2" x 1-3/8" x 2-7/8" deep.
Model S-005 same as above for Schlage locks.

005 US 4 Finish List \$ 65.83 ea.
S005 US 4 Finish 77.18

NUTONE TRANSFORMER FOR DOOR OPENERS

Transformer operates all door openers on this page. Use in conjunction with push-button below.

C905



C905 Transformer List/ea. \$ 26.18

NUTONE PUSHBUTTON

PB-CL



Round Pushbuttons for operating electric door openers on this page. Also see page 100 for a complete selection of decorator pushbuttons. 13/16" Dia.

PB-CL Clear Pushbutton List/ea. \$ 7.32

SECRET GATE LATCHES

Designed to restrict entry into fenced off areas in banks, stores, or public buildings. (Handle does not operate a latch.)

KNAPE & VOGT

Cast Aluminum. 3 per box.



989BR Brass Finish List/ea \$ 22.55
989AL Alum. Finish 22.55

PARKER

Solid Cast Brass. 1 per box.



551PC Chrome Plate List/ea \$ 29.07

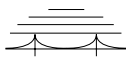

PET DOORS

Z INDUSTRIES PET DOORS

Deluxe Series Pet Doors

Colorful display box includes fasteners. Silver anodized frame will never rust. Easy installation in door or wall.



- Three sizes accommodate all pets: small cats to German Shepherds.
- Tough, long life, flexible rubber panel
- Permanent magnets keep door closed. No drafts or dust.
- Rigid hardboard security panel slips easily into guides on aluminum frames inside or outside.



<u>Code</u>	<u>Flap</u>	<u>Cut-out</u>	<u>Overall</u>
SD300	4-3/4 x 7-1/8	7-9/16 x 9-5/8	9-1/8 x 10-1/2
MD400	8-1/2 x 12-1/2	11-1/8 x 14-7/8	12-5/8 x 15-3/4
LD500	11-1/2 x 16-7/8	14 x 18-7/8	15-1/2 x 19-3/4
XLD600	14-1/2 x 19-1/2	17-1/4 x 21-7/8	18-3/4 x 22-3/4

<u>Code</u>	<u>Description</u>	<u>List/ea</u>
SD300	Small pet door	\$ 88.71
MD400	Medium pet door	111.18
LD500	Large pet door	149.65
XLD600	Xtra Large pet door	200.97



2-PIECE RUBBER ASSEMBLY

Special Order

Replacement Flap Pet Door

Spare part for the Deluxe Series Pet Doors shown above. Consists of a rubber flap and a rubber U-frame. Special Order.

<u>Code</u>	<u>Description</u>	<u>List/ea</u>
SD300A	For the SD300	\$ 41.00
MD400A	For the MD400	48.66
LD500A	For the LD500	80.58
XLD600A	For the XLD600	102.26



DOOR CLOSERS

NORTON **DOOR CLOSERS**

1600 Series

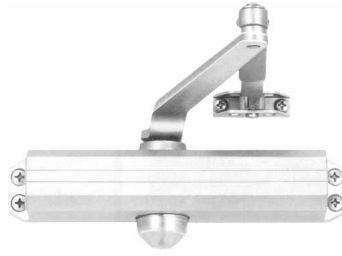

Series 1600 Norton closers with options for a variety of different installations. Use left or right handed without adapters. Regular or parallel arm applications with included adapter. Optional 90° - 180° holder arm or 90° - 180° fusible link holder arm. Adjustable power on closer and on door shoe. Two-tooth Rack-and-Pinion contact for smoother operation. Separate non-critical regulating valves for closing speeds and latch speed.

<u>Max Door Size</u>			<u>Max Door Size</u>		
<u>No.</u>	<u>Int.</u>	<u>Ext.</u>	<u>No.</u>	<u>Int.</u>	<u>Ext.</u>
1602	2' 8"	N/A	1604	3' 8"	3' 6"
1603	3' 2"	3' 0"	1605	4' 2"	4' 0"

Use next size larger closer (larger no.) when using parallel arm type installation or for inswinging exterior doors. 6 ea/case.

<u>Code</u>	<u>Finish</u>	<u>List/ea</u>
1602AL*	Aluminum	\$ 192.09
1602BZ	Bronze	192.09
1603AL	Aluminum	192.09
1603BZ	Bronze	192.09
1603-690	Dark Bronze	192.09
1603HAL	Alum. w/ Hold-Open	220.40
1603HBZ	Bronze " "	220.40
1604AL	Aluminum	192.09
1604BZ	Bronze	192.09
1605BZ*	Bronze	192.09
1605-690*	Dark Bronze	192.09

The 1602, 1604 and 1605 are also available with Hold-Open feature - Factory order.

NORTON HANDICAPPED **1600 SERIES**

With Barrier Free!

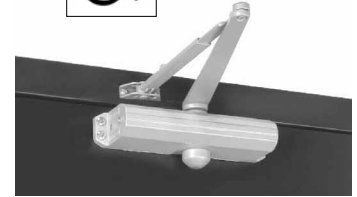

The Norton 1601BF door closer is basically the same as the other 1600 series closers, but has tremendous size flexibility. It fits interior doors up to 3' 8" and exterior doors up to 3' 6". The "BF" (Barrier Free) feature meets the requirements of the Americans with Disabilities Act (ADA) for reduced opening resistance.

Non-handed. Regular or parallel arm applications with included brackets. Adjustable spring power on closer. Two-tooth Rack-and-Pinion contact for smoother operation. Separate non-critical regulating valves for closing speeds, latch speed and back check. 6 ea/case.

<u>Code</u>	<u>Finish</u>	<u>List/ea</u>
1601BF-AL	Aluminum	\$ 192.09
1601BF-BZ	Bronze	192.09
1601BF-690	Dark Bronze	192.09



DOOR CLOSERS

NORTON 8501 SERIES



Adjustable on the door for sizes 2 through 6, meets exact wind or building pressure required. Back-check cushioning has separate adjustment valve for sweep latch and back-check. Non-handed; installs as regular, parallel arm, or top jamb. Aluminum alloy body, for a minimum interior door size of 30" and a maximum exterior door size of 48" (outswinging). "BF" indicates Barrier Free feature for low opening resistance. 4 ea/ case.

<u>Code</u>	<u>Description</u>	<u>List/ea</u>
8501BF-BZ	Sprayed Bronze, BF	\$ 271.96
8501BF-AL	Aluminum, BF	271.96
8501BF-STAT	Dark Bronze, BF	271.96
8501BFH-AL	Alum, BF, Hold-Open	300.27
8501BFH-STAT	Dark Bronze, BF, Hold-Open	300.27

NORTON 7500 SERIES

Special Order Only



Series 7500
Installed Regular Arm

Narrow projection control: 2-1/8" projection. Functions and options are similar to the 8501 except that the 7500 is heavier duty and more suited for institutional and heavy traffic applications. For a maximum interior door size of 32" and a maximum exterior door size of 48" (inswinging).

Has "BF" Barrier Free feature for low opening resistance. For "Delayed Action" feature specify "DA" after the product code and add \$ 10.00 to the List price. All Special Order.

<u>Code</u>	<u>Finish</u>	<u>List/ea</u>
7500BF-BZ	Sprayed Bronze	\$ 343.00
7500BF-AL	Aluminum	343.00

LCN SUPER 'SMOOTHEE' SERIES



2

The "Super Smoothee" was developed to answer the need for a single, non-handed, heavy duty door closer with spring power. Adjustable from sizes 2 through 6. Allow four day delivery.

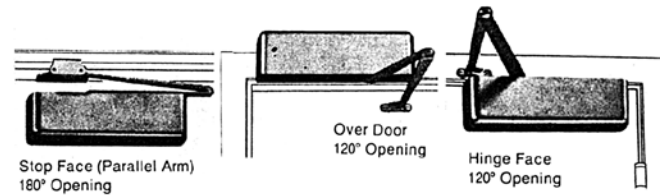

For Over Door Mounting:

1. Maximum Reveal: 2-9/16"
2. For reveals 2-9/16" through 4-13/16" (6-3/4" frame) please specify 4040-long rod.

The 4041 Series cylinders are adjustable from sizes 1 through 6. It is Barrier Free on sizes 1 through 5. Non-handed. Please Specify Aluminum or Bronze Finish.

<u>Code</u>	<u>Description</u>	<u>List/ea</u>
4041	Regular	\$ 406.00
4041H	Hold-Open	449.00
4041P	Parallel Arm	410.00

For "Delayed Action" feature add "DEL" to part number and add \$ 73.00 to the List.

LCN DOOR HANDING

The 4041 Series shown above is non-handed. When ordering the 4010/4110 Series shown on the following page, handing needs to be specified.

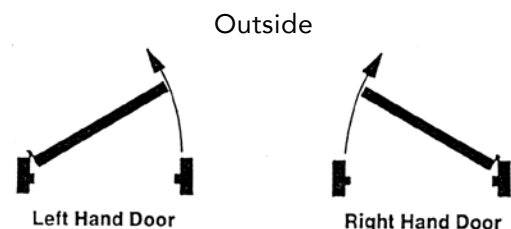



LCN

DOOR CLOSERS

2

The 4010 / 4110 SMOOTHEE™ Series is LCN's best performing heavy duty closer designed specifically for institutional and other rugged high traffic applications. Cast iron, forged steel closer arm, powder coated finish. UL & CUL listed (without hold-open), ANSI Standard A156.4, Grade One. Order the 4010 Series for Hinge Side Mount, order 4110 Series for Parallel Arm Mount. Specify hand of door when ordering. The 4011 and the 4111 have cylinders that meet ADA requirements.



Table of Sizes: Select closer based on width of door. The spring power of non-sized 4011 cylinder is adjustable from size 1 through size 5 and is shipped set to size 3. Sized 4010 series cylinders available in size 2, 3, 4, 5 or 6. Closing power of all 4010 Series closers may be increased 50%. Specify next higher size closer where strong draft exists.

→ Indicates recommended range of door width for closer size.

Exterior (and Vestibule) Door

	24"	30"	36"	42"	48"
	size 3	size 4	size 5	size 6	
*4011	→	→	→	→	→
4013	→	→	→	→	→
4014	→	→	→	→	→
4015	→	→	→	→	→
4016	→	→	→	→	→

Minimum Door Width

Interior Door Width

	24"	34"	38"	48"	54"	60"
	size 2	size 3	size 4	size 5	size 6	
*4011	→	→	→	→	→	→
4012	→	→	→	→	→	→
4013	→	→	→	→	→	→
4014	→	→	→	→	→	→
4015	→	→	→	→	→	→
4016	→	→	→	→	→	→

Minimum Door Width

4010 Series List \$ 416

Specify Aluminum or Bronze and Specify hand of door (chart on prev. page). Delivery time: 4 days. Add \$ 31.69 for DEL (delay of action)

* Reduced opening force on 4011 and 4111 closers. Caution!

Any manual door closer, including those certified by BHMA to conform to ANSI Standard A156.4, that is selected, installed and adjusted base on ADA or other reduced opening force requirements may not provide sufficient power to reliably close and latch a door. (Refer to LCN "Power Operators" for systems that meet reduced opening force requirements without effecting closing power.)

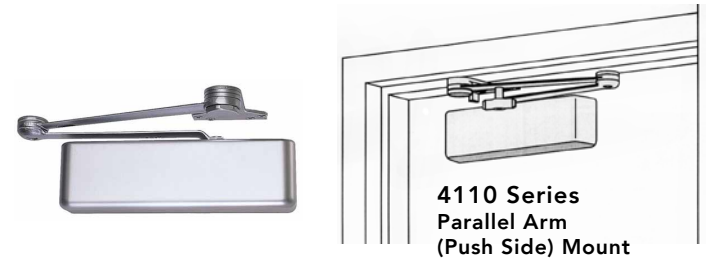

Table of Sizes: Select closer based on width of door. The spring power of non-sized 4111 cylinder is adjustable from size 1 through size 5 and is shipped set to size 3. Sized 4110 series cylinders available in size 2, 3, 4, 5 or 6. Closing power of all 4110 Series closers may be increased 50%. Specify next higher size closer where strong draft exists. Delayed action not available with 4115 or 4116 cylinder.

→ Indicates recommended range of door width for closer size.

Exterior (and Vestibule) Door

	24"	30"	36"	42"	48"
	size 3	size 4	size 5	size 6	
*4111	→	→	→	→	→
4113	→	→	→	→	→
4114	→	→	→	→	→
4115	→	→	→	→	→
4116	→	→	→	→	→

Minimum Door Width

Interior Door Width

	24"	34"	38"	48"	54"	60"
	size 2	size 3	size 4	size 5	size 6	
*4111	→	→	→	→	→	→
4112	→	→	→	→	→	→
4113	→	→	→	→	→	→
4114	→	→	→	→	→	→
4115	→	→	→	→	→	→
4116	→	→	→	→	→	→

Minimum Door Width

4110 Series List \$ 416

Specify Aluminum or Bronze and Specify hand of door (chart on prev. page). Delivery time: 4 days. Add \$ 31.69 for DEL (delay of action)

	Door Width	36"	42"	48"
	8.5* lbs.	4011/4111	4011/4111	4011/4111
	5.0* lbs.	4011/4111	4011/4111	4011/4111

* Maximum opening force



FLUSH BOLTS

SLIDING ACTUATOR TYPE FLUSH BOLTS

Flush bolts mortise into door edge and are actuated by sliding handle up and down.

TRIMCO: Forged brass, aluminum or bronze. Face: 6" long x 3/4" wide. Bolt: 1/2" diameter with 1" throw. 10 per box. Square End.



Code	Finish	List/ea
3999SE-605	Brt. Brass	\$ 12.13
3999SE-609	Ant. Brass	12.13
3999SE-625	Brt. Chrome	12.13
3999SE-626	Dull Chrome	11.12
3999SE-613	Oil R. Bronze	12.13
3999SE-619	Sat. Nickel	13.55

With Rounded End: 10/box

3999-605	Pol. Brass	12.13
3999-613	Oil R Bronze	15.09
3999-619	Satin Nickel	13.45

BALDWIN RESIDENTIAL FLUSH BOLT

Solid forged brass construction. Length: 6". 1" Throw. Sharply defined edge and recess. Smooth working action with automatic holding spring for both retracted and projected positions. High quality flush bolt not to be confused with wrought metal types. Packed with fasteners.

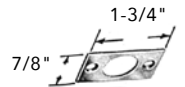

Code	Finish	List/ea
0626-030	Polished Brass	\$ 22.24
0626-050	Sat. Brass/Black	22.24
0626-060	Sat. Brass/Brown	22.24
0626-102	Oil R. Bronze	22.24
0626-260	Pol. Chrome	22.24
0626-264	Dull Chrome	22.24
0626-112	Venetian Bronze	22.24
0626-150	Satin Nickel	22.24
0626-151	Antique Nickel	22.24

LEVER ACTUATOR FLUSH BOLTS

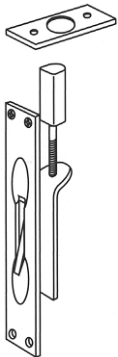

TRIMCO: Forged brass or bronze. Overall: 1" x 6-3/4", Throw: 11/16". Supplied w/ 12" rod. 1 per pack.

Code	Finish	List/ea
3917-12-605	Brt. Brass	\$ 25.72
3917-12-613	Oil R. Bronze	25.82
3917-12-626	Dull Chrome	20.59
3917-12-625	Pol.Chrome	30.33
3917-12-619	Sat. Nickel	33.37

BALDWIN EXTENSION FLUSH BOLT

Solid hot forged brass extension flush bolt has over 3/4" throw. Unique push button design of lever and delay action for easy operation. Lever does not engage bolt until it is hinged freely to 45° angle. At this position it is easy to move the bolt head. Lever snaps automatically when hinged beyond 45° angle. Made to template for easy installation in metal door frames. Faceplate: 1" x 6.75", Rod: 12". Packed with fasteners.

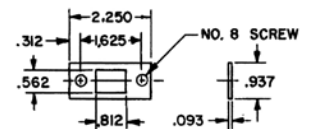

Code	Finish	List/ea
0600-030	Polished Brass	\$ 28.31
0600-050	Satin Brass/Black	28.31
0600-102	Oil R Bronze	28.31
0600-260	Polished Chrome	28.31
0600-264	Dull Chrome	28.31
0600-112	Venetian Bronze	28.31
0600-150	Satin Nickel	28.31
0600-151	Antique Nickel	28.31



FLUSH BOLTS

IDH FLUSH BOLT

Solid Brass

6" Flush Bolt
with Square End

Length: 6"
Width: 3/4"
Throw: 1"
Strike: 7/8" x 1-3/4"

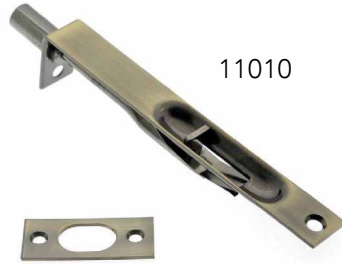

11010

- Smooth sliding
- Double action spring holds bolt in retracted or extended positions

Code	Finish	Ctn	List/ea
11010-003	Polished Brass	10 ea.	\$ 14.05
11010-005	Antique Brass	10	17.19
11010-015	Satin Nickel	10	17.19
11010-026	Polished Chrome	10	17.19
11010-10B	Oil R Bronze	10	17.19
11010-15A	Antique Nickel	10	17.19
11010-26D	Satin Chrome	10	17.19

IDH EXTENSION FLUSH BOLT

Solid Brass

12" Extension Flush Bolt

Length: 6-3/4"
Width: 1"
Throw: 1"
Strike: 2" x 1"
Strike: 2-1/2" x 1"

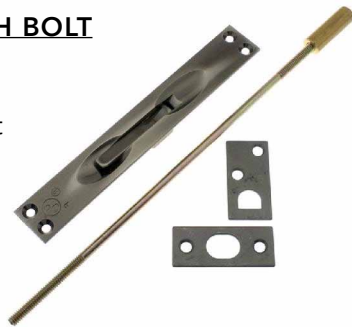

Code	Finish	Ctn	List/ea
11020-003	Polished Brass	10 ea.	\$ 24.00
11020-005	Antique Brass	10	28.00
11020-015	Satin Nickel	10	28.00
11020-026	Polished Chrome	10	28.00
11020-10B	Oil R Bronze	10	28.00
11020-26D	Satin Chrome	10	28.00

ERIC MORRIS

EXTENSION FLUSH BOLT

Solid Brass extension bolt has a 3/4" throw. Lever engages bolt approx. 45° for greater leverage and easier operation. Lever snaps home in both closed and open positions.

Length: 6.75", Width: 1", Bolt: 1/2"
Throw: 3/4"

Polybagged with fasteners and 12" rods.



Code	Finish	Ctn	List/ea
2202-605	Polished Brass	2	\$ 52.00
2202-613	Oil Rubbed Bronze	2	52.00
2202-619	Satin Nickel	2	52.00

ERIC MORRIS HIGH SECURITY RESIDENTIAL FLUSH BOLT

Solid extruded brass construction. Lever engages bolt at approximately 45° for greater leverage and easier operation. Lever snaps home in both closed and open positions. The lever design offers the security of an extension bolt with the smaller size and ease of installation of a residential flush bolt.

Length: 6", Width: 3/4"
Bolt: 1/2", Throw: 3/4"
Polybagged 4 each per box with fasteners.



Code	Finish	Ctn	List/ea
2203-605E	Pol. Brass, Lifetime	4	\$ 65.00
2203-613	Oil R. Bronze	4	52.00
2203-619	Satin Nickel	4	52.00
2203-605	Polished Brass	4	52.00



IVES

AUTOMATIC FLUSH BOLTS

FB31P FLUSH BOLT FOR METAL DOORS

Automatic

Top and Bottom Bolts

Both bolts are non-handed, but are not identical. The top bolt has no spring tension, resulting in lower actuation force with a smoother operation.



FB31P Pair

- Fully Automatic - inactive door is latched when active door closes, bolts retract when active door is opened.
- Low Actuation Forces - Top Bolt Has No Spring Tension.
- UL Listed for Fire Doors.
- Fits standard ANSI A115.4 Door Frame Preparations.
- Non-handed.
- Finishes: US3, US4, US10, US10B, US32, US32D.
- Bolts have 3/4" throw with a 7/8" vertical adjustment.
- Standard Rod Length is 12", which is measured from the center of the flush bolt body to the bolt tip.
- Meets ANSI A156.3 Type 25.
- UL Listed 3 hours on 8'0" x 10'0" Opening.

Dimensions:

Body Size: 1" W x 6-3/4" L x 2" D
Guide Size: 1" W x 1-27/32" L x 27/32" Ht x 3/32" Thick
Strike Size: 15/16" W x 2-1/4" L x 1/16" Thick
Rub Plate Size: 1-1/4" W x 1-11/16" L x 3/64" Thick

<u>Code</u>	<u>Finish</u>	<u>List/pr.</u>
FB31P	All Finishes	\$ 162.38

Special Order Only.

FB41P FLUSH BOLT FOR WOOD DOORS

Automatic

Top and Bottom Bolts

Both bolts are non-handed, but are not identical. The top bolt has no spring tension, resulting in lower actuation force with a smoother operation.



FB41P Pair

- Fully Automatic - inactive door is latched when active door closes, bolts retract when active door is opened.
- Low Actuation Forces - Top Bolt Has No Spring Tension.
- UL Listed for Fire Doors.
- Non-handed.
- Finishes: US3, US4, US10, US10B, US32, US32D.
- Bolts have 3/4" throw with a 7/8" vertical adjustment.
- Meets ANSI A156.3 Type 25.
- UL Listed 90 minutes on 8'0" x 8'0" Opening.

Dimensions:

Body Size: 1" W x 8-1/2" L x 2" D
Guide Size: 1" W x 6" L x 1/8" Thick
Strike Size: 15/16" W x 2-1/4" L x 1/16" Thick
Rub Plate Size: 1-1/4" W x 1-11/16" L x 3/64" Thick

<u>Code</u>	<u>Finish</u>	<u>List/pr.</u>
FB41P	All Finishes	\$ 171.36

Special Order Only.

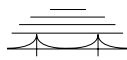

THRESHOLDS

PEMKO THRESHOLDS

2

Threshold for low rug design.
Shown with P210 door shoe.
(Door shoe not included.)



P212

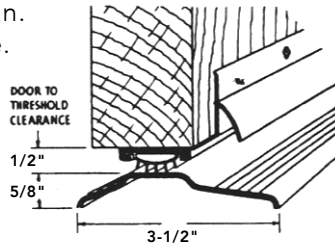

Code	Size	Finish	List/ea
P212A	36"	Mill Finish	\$ 17.98
P212D	36"	Dura. Bronze	25.24
P212BDG	36"	Bright Dip. Brass	28.02
P212D-6	72"	Dura. Bronze	50.98

Threshold for high rug design.
Shown with P210 door shoe.
(Door shoe not included.)



P214

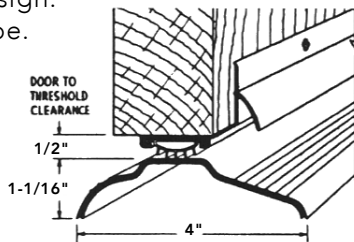

Code	Size	Finish	List/ea
P214A	36"	Mill Finish	\$ 24.09
P214D	36"	Dura. Bronze	31.49
P214D-6	72"	Dura. Bronze	62.98

PEMKO

PEMKO WATER RETURN INTERLOCKING THRESHOLD

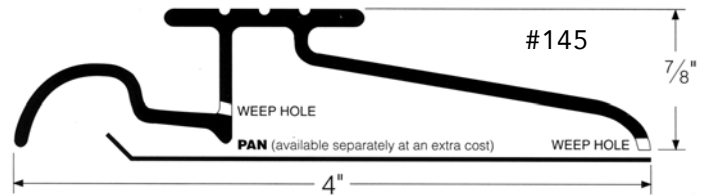

Catches any water which may blow or run under door and returns it to the outside. #61 hook is furnished with threshold. Optional Drain pan **Special Order**.

Code	Size	Finish	List/ea
145A-3	36"	Aluminum	\$ 29.12
145D-3	36"	Dura. Bronze	46.56
145A-6	72"	Aluminum	64.59
145D-6	72"	Dura. Bronze	88.81

Can also be special ordered in B, BDG, G, PW and SN finishes (see chart below).

PEMKO INTERLOCKING THRESHOLD

Special Order - Call for Price

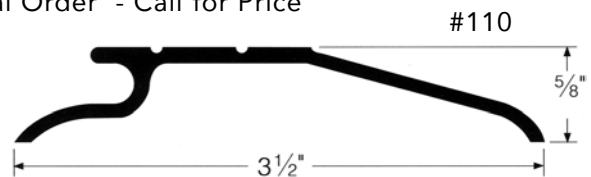

Interlocking threshold comes with #61 hook and nails, but may be fitted with a variety of hooks, according to need.

Special Order in A, B, D or G finishes (see chart below).

HOOKS - Special Order

When installed properly on bottom of door, hooks interlock with threshold for a tight seal. BHMA certified.

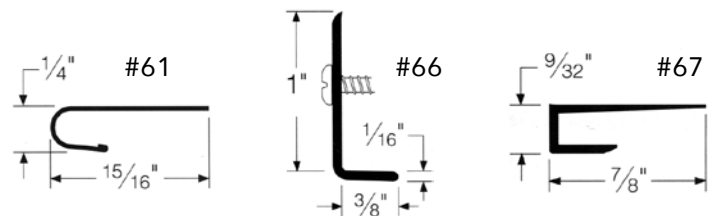

Finish Codes:

A	Mill Finish Aluminum	G	Gold (Ano. Alum.)
B	Ext. Bronze (Brass)	PW	Painted Wht Alum
BDG	Bright Dipped Gold	SN	Satin Nickel
D	Dark Bronze (Ano. Alum.)		

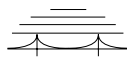

THRESHOLDS

AUTOMATIC DOOR BOTTOM

Surface Mount

Lifts to clear rugs,
shuts to seal out
weather.

10 per box.

Code	Finish	Size	List/ea
SA2	Mill Finish	30" - 32" Door	\$ 42.46
SA3	Mill Finish	34" - 36" Door	40.34
SA2D	Dark Bronze	30" - 32" Door	47.52
SA3D	Dark Bronze	34" - 36" Door	48.94

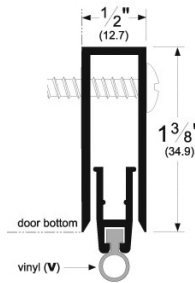
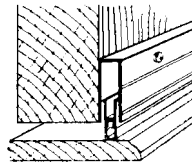

AUTOMATIC DOOR BOTTOM Full Mortise

Special Order - Call for Price



#411ARL

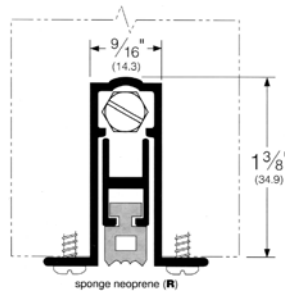

Special Order. Specify 36" or 48" length. Available in Mill Finish Aluminum.

RAIN DRIP

Aluminum deflects rain away from bottom or top of door or window. Heavy duty, screw-on. Length: 36". Aluminum finish provided with a Vinyl insert.



P345AV

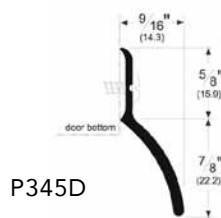
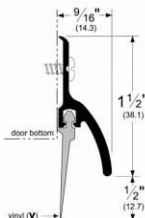

P345D

Code	Finish	Ctn	List/ea
P345D	Dark Brz Anod.	10	\$ 10.19
P345AV	Aluminum	10	10.55

PEMKO

DOOR SHOES

Door shoe with drip lip fits doors 1-3/8" and larger. 36" long, Black insert.



10 per carton.

Code	Size	Finish	List/ea
P210AV	36"	Mill Finish	\$ 11.62
P210DV	36"	Dura. Bronze	15.23
P210BDGV	36"	Bright Brass	17.62

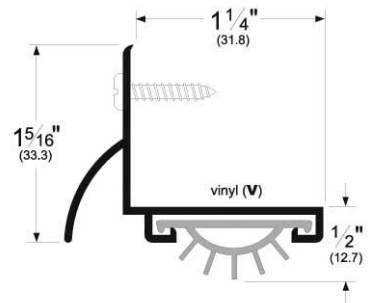

P210AV: Extruded Aluminum, slotted holes, vinyl insert

DOOR SHOES

Door shoe with drip lip. 215 model for 1-3/8" doors, 216 model is for 1-3/4" doors. Black insert.

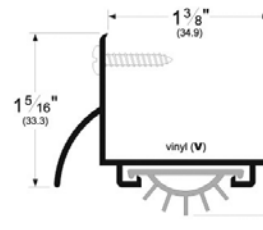

215

For 1-3/8" Door

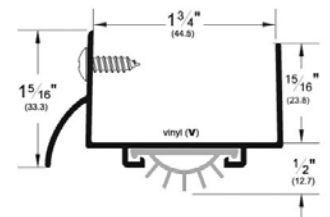

216

For 1-3/4" Door

Code	Finish	Ctn	List/ea
P215DV	Dark Brz/Vinyl, 36"	10	\$ 18.00
P215AV	Aluminum/Vinyl, 36"	10	13.87
P216DV	Dark Brz/Vinyl, 36"	10	17.59
P216AV	Aluminum/Vinyl, 36"	10	13.83
P216GV	Gold Anod/Vinyl, 36"	10	20.02

DOOR SWEEP

This brush gasketing is supplied with a Nylon Brush insert. 36" length, Dark Bronze finish.

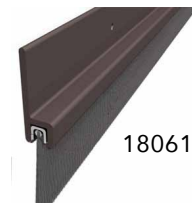

18061

Code	List
18061DNB36	\$ 16.43

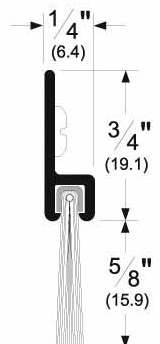



PEMKO

WEATHERSTRIP

DOOR SWEEP

2

Aluminum & vinyl door sweep.
Length: 36". 10 per ctn.



P307DV

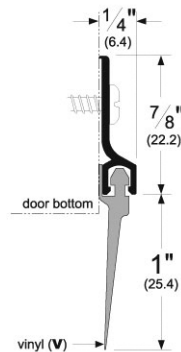

Code	Description	List/ea
P307AV	Aluminum & Vinyl	\$ 6.37
P307DV	Dark Bronze & Vinyl	9.10
P307GV	Gold Anod. & Vinyl	10.19
P307WV	Paint White & Vinyl	8.41

GARAGE DOOR WEATHERSTRIP

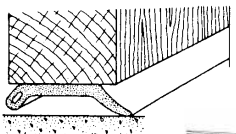

P364

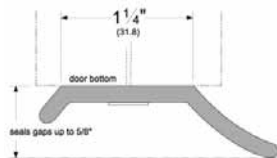

Garage door weatherstrip in coils for single & double garage doors. Neoprene. 10 per ctn.

Code	Size	List/ea
P364-16	16' Coil	\$ 27.96

SILICON SEAL PRESSURE SENSITIVE DOOR GASKETING

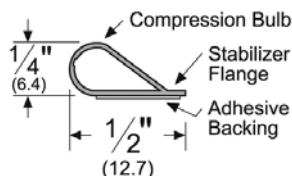
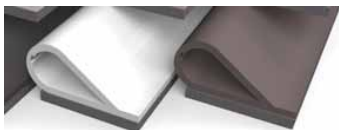

Silicon Seal adhesive-backed fire/smoke gasketing. Begins compressing at 1/4" and can be compressed sufficiently to seal 1/16" toleranced openings. Will not lose its form. 21' coil.

S88W-21	21', White	List \$ 28.87 ea.
S88D-21	21', Dark Bronze	29.74

WEATHERSTRIP PRODUCTS

Spring Bronze Weatherstrip

Spring metal weatherstrip in 17' sets to fit standard doors to 36" wide & 84" tall. 10 per ctn.

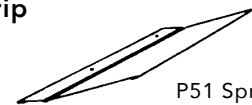

P51 Spring Metal

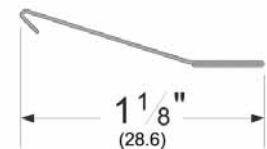

Code	Finish	List/ea
P51B	Bronze	\$ 42.97

Bronze cushion metal weatherstrip in 17' sets to fit doors 36" wide and 84" tall. 10 per ctn.

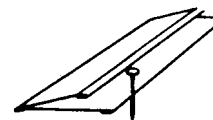

P74B-17
Bronze Cushion Metal

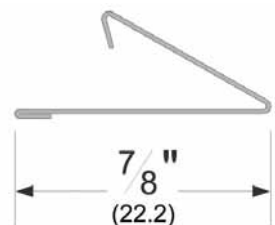

Code	Finish	List/ea
P74B-17	Bronze	\$ 60.66

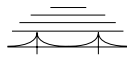

GASKET

SYSTEM "V" WEATHERSTRIP TAPE

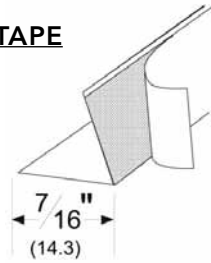

The fold, peel & stick flexible weatherstrip which compresses to seal against air, dust & sound with a five year replacement guarantee. 7/8" x 17'.

7/16" when folded. 10 rolls per box.

Code	Finish	List/rl
P39C-17	Clear	\$ 10.31

FOAM TAPE

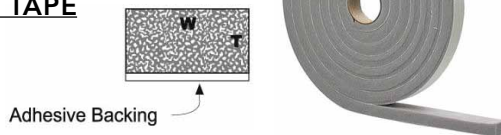

Self-adhesive strips of open cell (soft & resilient) polyurethane tape in 17' coils. Use for weatherstrip, cushions, and insulation. 10 rolls/box.

Code	Color	Size	List/rl
P390	Gray	3/16" T x 3/8" W x 17' L	\$ 4.99
P391	White	1/4" T x 3/8" W x 17' L	5.16
P392	Gray	3/8" T x 3/8" W x 17' L	7.19
P393	Gray	1/2" T x 1/2" W x 17' L	9.10
P394	Gray	1/2" T x 3/4" W x 17' L	13.80
P396	Charcoal	1/4" T x 1/2" W x 17' L	5.83
P397	White	1/8" T x 3/8" W x 17' L	4.85
P398	Gray	1/4" T x 3/4" W x 17' L	12.54

SPONGE NEOPRENE CLOSED CELL ADHESIVE TAPE



Code	Color	Size	List/rl
P380	Black	3/16" T x 3/8" W x 10' L	\$ 3.64
P381	Black	5/16" T x 3/8" W x 10' L	4.68
P382	Black	5/16" T x 3/4" W x 10' L	9.37
P384	Black	7/16" T x 3/4" W x 10' L	12.62
P388	Black	5/16" T x 1/2" W x 10' L	6.06

GASKET FROM SIMONSWERK / TECTUS

Designed for flush exterior and interior door assemblies

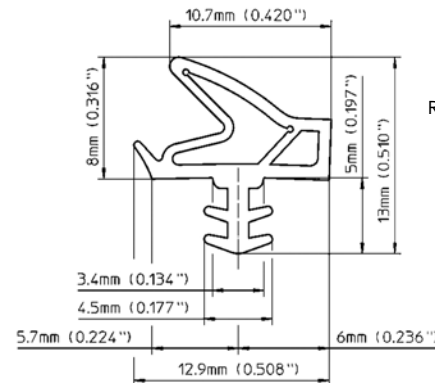

Beige



Rustic Brown

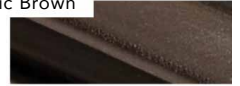

Black



White



- Large contact range to compensate for door warpage
- Low memory loss to maintain functionality
- Excellent physical and thermal properties
- Exceptional resilience
- Smooth and consistent closing pressure
- Temperature range from -104°F to +356°F
- Highly resistant to aging, weather, UV light and ozone

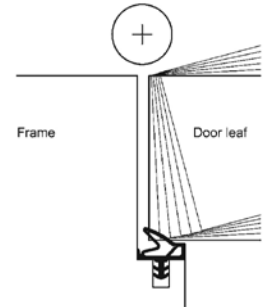

Technical Data

Material	Thermoplastic elastomer (TPE)
Width	12mm (0.472")
Depth	13mm (0.512")

Colors

Beige	similar to RAL 1004
Rustic brown	similar to RAL 8014
Black	similar to RAL 9004
White	similar to RAL 9016

Application Range: Smoke Resistance, Soundproof

Pack: 82' per bag. Full Bags Only.

Code	Finish	List/bg
GASKET-BE	Beige	\$ 65.88
GASKET-BR	Rustic Brown	65.88
GASKET-BL	Black	65.88
GASKET-WH	White	65.88