

STANDARDS & BRACKETS

KV 80 SLOTTED STANDARD
Steel

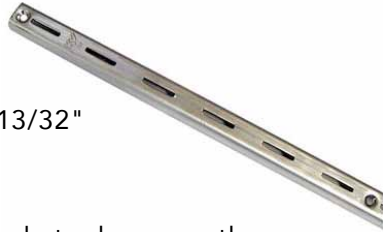

1" Adjustment,
Width: 5/8", Height: 13/32"
All sizes 10/box.

Use with the KV 180 Brackets shown on the following page. Pack: 10 each/box.

Anochrome

Code	Size	List/ea
80A-12	12"	\$ 3.26
80A-24	24"	3.59
80A-36	36"	5.79
80A-48	48"	7.00
80A-60	60"	9.45
80A-72	72"	11.93
80A-84	84"	13.57
80A-96	96"	14.68

Brass

Code	Size	List/ea
80BR-72	72"	\$ 13.06

Ebony, Black

Code	Size	List/ea
80EB-36	36"	\$ 7.67
80EB-48	48"	7.79
80EB-72	72"	12.60

White

Code	Size	List/ea
80WH-24	24"	\$ 4.50
80WH-36	36"	6.49
80WH-48	48"	9.03
80WH-60	60"	9.71
80WH-72	72"	14.14

Screws for KV 80 Standards

Sold in full bags only. 6 screws and anchors per bag.

Code	Finish	List/bg
80-88DP ANO	Anochrome	\$ 3.27
80-88DP EB	Black	3.11
80-88DP WH	White	3.27

KV 180 BRACKETS
Steel



1" Adjustment
Use with KV 80 standards

Pack: 10 each/box.

Anochrome

Code	Size	List/ea
180A-6	6"	\$ 2.98
180A-8	8"	3.01
180A-10	10"	3.01
180A-12	12"	4.52
180A-14	14"	4.26
180A-16	16"	4.34
180A-18	18"	5.27
180A-20	20"	6.90

Brass

Code	Size	List/ea
180BR-6	6"	\$ 4.06
180BR-8	8"	3.66
180BR-10	10"	4.05
180BR-12	12"	4.16

Ebony, Black

Code	Size	List/ea
180EB-6	6"	\$ 3.42
180EB-8	8"	3.06
180EB-10	10"	3.70
180EB-12	12"	3.57
180EB-14	14"	4.52
180EB-16	16"	5.13

White

Code	Size	List/ea
180WH-6	6"	\$ 3.68
180WH-8	8"	3.59
180WH-10	10"	3.49
180WH-12	12"	3.69
180WH-14	14"	5.30
180WH-16	16"	5.14



KV BRACKETS

KV 183 HEAVY DUTY FLANGED BRACKET

Steel, Anochrome finish



Right, Left, Center
Heavy Duty
#183 angle Slot bracket
(1" increments)

Rights/Lefts priced the same. Pack: 10 each.

Left	Right	List	Center	List
183A-L-8	183A-R-8	\$ 6.94	183A-C-8	\$ 10.88
183A-L-10	183A-R-10	7.10	183A-C-10	11.17
183A-L-12	183A-R-12	7.87	183A-C-12	11.57
183A-L-14	183A-R-14	9.00	183A-C-14	13.86
183A-L-16	183A-R-16	10.28	183A-C-16	15.03
183A-L-18	183A-R-18	11.42	183A-C-18	16.61
183A-L-20	183A-R-20	13.51	183A-C-20	18.04

KV 185 HEAVY DUTY DOUBLE BRACKET

Steel, Anochrome finish



Heavy Duty #185
Double Slot bracket
(1" increments)

Pack: 10 each

Code	List/ea	Code	List/ea
185A-8	\$ 10.74	185A-18	\$ 13.34
185A-10	10.25	185A-20	17.83
185A-12	10.43	185A-22	22.49
185A-14	11.98	185A-24	21.93
185A-16	13.42		

RESTS FOR #186/#187 BRACKETS Anochrome



Center Rest
#211



Front Rest
#212KV

211	Center Rest	100/bx	\$ 118.09/C
212KV	Front Rest	100/bx	1.16/ea

RUBBER CUSHION

for #103, #104, #105, #210 & #211, #212 rests



#129
Cushion
100/bx List \$.33/ea

KV 186 & KV 187 HEAVY DUTY BRACKETS

Steel, Anochrome finish, 2" Increments



#186 Slot bracket
Extra Heavy Duty



#187 Slot bracket
Extra Heavy Duty

Pack: 5 each

Code	List/ea	Code	List/ea
186A-8	\$ 8.37	187A-18	\$ 13.84
186A-10	8.75	187A-20	18.49
187A-12	10.35	187A-22	19.75
187A-14	11.28	187A-24	21.28
187A-16	12.35		

Import version Pack: 10 each

Code	List/ea	Code	List/ea
187-8	\$ 6.01	187-18	\$ 12.32
187-10	7.51	187-20	16.47
187-12	8.91	187-22	17.60
187-14	10.04	187-24	18.99
187-16	11.31		

KV 160 LOCK LEVER BRACKETS

Steel, Anochrome finish, 1" Increments



#160 Lock Lever bracket

Features stabilizing lock-lever. Ideal for high traffic displays. Other sizes available Special Order.

Code	Size	Ctn	List/ea
160A-12	12"	10 ea.	\$ 5.61

KV 179 ADJUSTABLE SLANT BRACKETS

Steel, Anochrome finish, 1" Increments



#179 Adjustable bracket

Adjustable to 15°, 30°, 45° and 90°.

Code	Size	Ctn	List/ea
179A-10	10"	10 ea.	\$ 12.52
179A-12	12"	10	13.15
179A-14	14"	10	13.87

SHELF STANDARDS

KV 71 - NARROW STANDARD - Special Order

Steel, Anochrome finish, 1" Increments

Code	Size	Ctn	List/ea
71A-4*	48"	10 ea.	\$ 29.00
71A-5*	60"	10	35.00
71A-6*	72"	10	42.00
71A-8*	96"	10	48.00

KV 83 - HEAVY DUTY OVERSIZED STANDARD

Steel, Anochrome finish, 1" Increments

Code	Size	Ctn	List/ea
83A-2	24"	10 ea.	\$ 6.37
83A-3	36"	10	7.49
83A-4	48"	10	10.64
83A-5	60"	10	13.43
83A-6	72"	10	15.00
83A-7	84"	10	18.86
83A-8	96"	10	19.18

KV 85 - DBL SLOTTED HEAVY DUTY STANDARD

Steel, Anochrome finish, 1" Increments

Code	Size	Ctn	List/ea
85A-2*	24"	10 ea.	\$ 6.89
85A-3	36"	10	9.20
85A-4	48"	10	11.54
85A-5	60"	10	14.73
85A-6	72"	10	17.33
85A-7	84"	10	20.33
85A-8	96"	10	25.30

KV 87 - EXTRA HEAVY DUTY STANDARD

Steel, Anochrome finish, 2" Increments

Pack: 5 each.

Code	Size	List/ea	Code	Size	List/ea
87A-2	24"	\$ 12.27	87A-6	72"	\$ 33.78
87A-3	36"	17.32	87A-7	84"	45.31
87A-4	48"	24.13	87A-8	96"	42.61
87A-5	60"	28.26			

Import version Pack: 10 each

Code	Size	List/ea	Code	Size	List/ea
87-24	24"	\$ 10.50	87-72	72"	\$ 30.07
87-36	36"	15.41	87-84	84"	34.99
87-48	48"	21.40	87-96	96"	39.92
87-60	60"	25.13			



#71 Slotted Narrow
5/16" Width
13/32" Deep

#83 Slotted Heavy Duty Oversized
3/4" Width
1/2" Deep

#85 Double Slotted Heavy Duty
1-1/4" Width
1/2" Deep

#87 Slotted Extra Heavy Duty
7/8" Width
11/16" Deep

#71, 83, 85 are 1" increments, #87 are 2" increments

		STANDARDS																				
		51	56	70	71	80	81	82	83	85	87	90	91	92	96	97	98	144	146	148	233	255
BRACKETS	52	X																				
	57		X																			
	159		X	X	X	X	X	X	X	X	X	X	X	X	X	X	X	X	X	X	X	X
	160		X	X	X	X	X	X	X	X	X	X	X	X	X	X	X	X	X	X	X	X
	161		X	X	X	X	X	X	X	X	X	X	X	X	X	X	X	X	X	X	X	X
	170		X	X	X	X	X	X	X	X	X	X	X	X	X	X	X	X	X	X	X	X
	171						X	X	X	X	X	X	X	X	X	X	X	X	X	X	X	X
	173						X	X	X	X	X	X	X	X	X	X	X	X	X	X	X	X
	175						X	X	X	X	X	X	X	X	X	X	X	X	X	X	X	X
	177		X	X	X	X	X	X	X	X	X	X	X	X	X	X	X	X	X	X	X	X
	179						X	X	X	X	X	X	X	X	X	X	X	X	X	X	X	X
	180						X	X	X	X	X	X	X	X	X	X	X	X	X	X	X	X
	182								X													
	183						X	X	X	X	X	X	X	X	X	X	X	X	X	X	X	X
	184								X													
	185									X												
	186										X											
	187											X										
	194						X	X	X	X	X	X	X	X	X	X	X	X	X	X	X	X
	195						X	X	X	X	X	X	X	X	X	X	X	X	X	X	X	X
	196										X											
	197										X											
	204																					
205																						
206																						
228																					X	
229																					X	X

Standards & Bracket Selection Chart

This chart lists all of the many standards and brackets manufactured by Knap & Vogt. It will enable you to determine which bracket to use with each standard.



KV STANDARDS

KV STANDARDS 233 Surface Mount



Steel, Surface Mounted,
1/2" increments.

13/16" Width x 3/16" Deep.

Use Shelf Supports on
following page.

Code	Description	Ctn	List/ea
233ZC-24	Zinc (Steel), 24"	100	\$ 1.16
233ZC-36	" " 36"	100	1.63
233ZC-48	" " 48"	100	2.67
233ZC-60	" " 60"	100	2.97
233ZC-72	" " 72"	50	3.46
233ZC-96	" " 84"	50	4.89

KV STANDARDS 255 Flush or Surface Mount

Flush or Surface Mounted,
1/2" increments.

5/8 Width x 3/16" Deep.

Use Shelf Supports on
following page.



Steel, Zinc Finish

Code	Description	Ctn	List/ea
255ZC-24	Zinc, 24"	100	\$.95
255ZC-30	" 30"	100	1.32
255ZC-36	" 36"	100	1.54
255ZC-48	" 48"	100	2.15
255ZC-60	" 60"	100	2.54
255ZC-72	" 72"	50	3.06
255ZC-84	" 84"	50	3.64
255ZC-96	" 96"	50	4.08

(cont. next column)

KV STANDARDS 255 continued

Steel, Almond Finish



Code	Description	Ctn	List/ea
255ALM-24	Almond, 24"	100	\$ 1.73
255ALM-36	" 36"	100	3.67
255ALM-84	" 84"	50	6.55

Steel, Brass Finish



Code	Description	Ctn	List/ea
255BR-24	Brass, 24"	100	\$ 1.82
255BR-36	" 36"	100	2.52
255BR-48	" 48"	100	3.65
255BR-72	" 72"	50	5.31
255BR-84	" 84"	50	6.36
255BR-96	" 96"	50	7.24

Steel, White Finish



Code	Description	Ctn	List/ea
255WH-18	White, 18"	100	\$ 1.66
255WH-24	" 24"	100	1.76
255WH-36	" 36"	100	2.54
255WH-48	" 48"	100	3.47
255WH-60	" 60"	100	4.25
255WH-72	" 72"	50	5.18
255WH-84	" 84"	50	6.06
255WH-96	" 96"	50	6.86

Aluminum, Natural Aluminum Finish



Code	Description	Ctn	List/ea
255AL-18	Alum, 18"	100	\$ 1.00
255AL-24	" 24"	100	1.44
255AL-30	" 30"	100	1.43
255AL-36	" 36"	100	1.60
255AL-48	" 48"	100	2.19
255AL-60	" 60"	100	3.07
255AL-72	" 72"	50	3.09
255AL-84	" 84"	50	3.96
255AL-96	" 96"	50	4.23

Aluminum, Walnut Finish



Code	Description	Ctn	List/ea
255ALWAL-24	" 24"	100	\$ 2.01
255ALWAL-36	" 36"	100	2.76
255ALWAL-48	" 48"	100	3.73
255ALWAL-60	" 60"	100	4.79
255ALWAL-72	" 72"	50	5.47
255ALWAL-84	" 84"	50	7.76
255ALWAL-96	" 96"	50	7.78

SHELF SUPPORTS

NAILS FOR KV 255 STANDARDS

Pack: 650/bag. No broken bags.



Code	Finish	Pack	List/bg
255-81 ALM	Almond	650/bg	\$ 11.09
255-81 BR	Brass	650	8.49
255-81 STB	Bronze	650	9.06
255-81 WH	White	650	11.60
255-81 ZC	Zinc	650	10.88

KV 256 SHELF SUPPORTS

Use with KV 233 and 255 Standards

Pack: 100/Ctn.
Full Cartons Only.



#256 Support
(1/2" increments)

Code	Finish	Ctn	List/C
256ZC	Zinc (Steel)	100	\$ 20.99
256BR	Brass (Steel)	100	34.38
256WH	White (Steel)	100	44.53
256ALM	Almond (Steel)	100	50.40
256WAL	Walnut (Steel)	100	28.01
256ALNAT	Natural Aluminum	100	29.40

KV 256 BULK PACK

Pack: 1000/Ctn.
Full Cartons Only.



Code	Finish	Ctn	List/M
256B-ZC	Zinc (Steel)	1000	\$ 150.90

KV 256 IN POLYBAGS

12 each per bag,
10 bags per box.



Code	Finish	Ctn	List/bg
256P-BR	Brass	10 bags	\$ 4.92
256P-WH	White	10	8.01
256P-WAL	Walnut	10	5.11

KV 237 STEEL SHELF SUPPORTS

Use with KV 233 Standards

Zinc Finish.



#237 Support
(1/2" increments)

Code	Ctn	List/C
237ZC	100	\$ 27.46

KV 238 SHELF SUPPORTS w/ Locater Tab

Use with KV 233 Standards

Anochrome Finish.



#238 Support
(1/2" increments)

Code	Ctn	List/C
238	100	\$ 50.20

KV 239 STEEL SHELF SUPPORTS

Use with KV 233 and 255 Standards

Zinc Finish.



#239 Support
(1/2" increments)

Code	Ctn	List/C
239ZC	100	\$ 29.05

KV 243 SHELF SUPPORTS

Use with KV 233 and 255 Standards

Zinc Finish.
With 3" Cross Support



#243 Support
(1/2" increments)

Code	Ctn	List/ea
243ZC	100	\$ 2.41

With Rubber Cushion:
243RZC 100 2.43

SHELF SUPPORTS

STEEL SHELF SUPPORTS

- KV 345: 5mm Pin**
- KV 346: 1/4" Pin**
- KV 348: 5mm Pin (w/ vinyl cover)**
- 2607: 1/4" Pin**
- 2707: 5mm Pin**



Code	Finish	Pin	Ctn	List/C
345BR	Brass	5mm	100 ea.	\$ 34.19
346NP	Nickel	1/4"	100	32.16
346BR	Brass	1/4"	100	30.02
346WAL	Walnut	1/4"	100	30.09
348ALM	Almond	5mm	100	35.15
348BROWN	Brown	5mm	100	38.76
2607BN	Nickel	1/4"	1000	\$ 14.07
2607PB	Brass	1/4"	1000	14.30
2707BN	Nickel	5mm	1000	14.46
2707PB	Brass	5mm	1000	14.46
2707AC	Ant. Copper	5mm	1000	14.97

SHELF SUPPORT

With 5mm (3/16") steel pivot pin. Plastic coated.

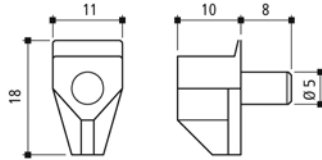

Code	Color	Ctn	List
HD161-CL*	Clear	1000	5.96 /C
SC5MM-CL	Clear	100/bg	10.20 /bg
SS23-WH	White	5000	58.50 /M

* Full Carton Only

SWEDISH TYPE SHELF SUPPORT

Insert into pre-drilled holes; the shelves are then simply put on the supports, or kerfed to slip over supports.
Dia: 3mm. Length: 8.82".
Galvanized steel wire. 100 per box.



282.71.712 List \$ 39.67/C

PLUG-IN SPOON-SHAPED SHELF SUPPORTS

Steel Stud in 5mm or 1/4" Pins



Pack: 100 each.

Code	Finish	Pin	List
SC5MM-PB	Brass	5mm	\$ 7.59
SC5MM-NI	Nickel	5mm	7.01
2306AC	Ant. Copper	5mm	6.92
SC14-PB	Brass	1/4"	6.74
SC14-NI	Nickel	1/4"	6.48

KV 333 SUPPORT



Steel, Bright Zinc Plate.

Pin Dia: 7/32"; use 15/64" diameter drill.
Pin Length: 1/2", Shelf Rest - 9/16" W x 7/16" L

Code	Ctn	List/C
333KV	1000	\$ 32.11

PLUG-IN SHELF SUPPORTS

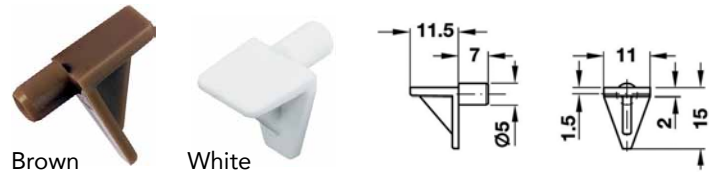

Plastic shelf support with a grooved 5mm stud. (sizes are in mm).

Code	Finish	Ctn	List/C
283.63.117	Brown	500 ea.	\$ 5.23
283.63.715	White	500	4.03

Plastic shelf support with a galvanized steel 5mm stud:

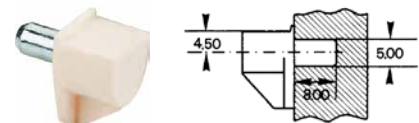

02.7854.728.5 Beige 100 ea. \$ 7.79/C

SHELF SUPPORTS

BAINBRIDGE PLASTIC SHELF CLIPS

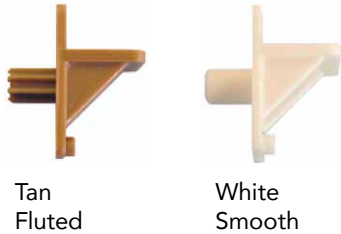

Pin Dia: 1/4" or 5mm
Pin Length: 11/32"
Smooth or Fluted Stem
Ctn. Qty: 10,000 each

1811 - 1/4" Diameter Pins

Code	Color	Stem	List/M
1811FL	Tan	Fluted	\$ 95.00
1811FC-50	Clear	Fluted	93.56
1811W-FL	White	Fluted	95.00
1811-	Tan	Smooth	65.08

3811 - 5mm Diameter Pins

Code	Color	Stem	List/M
3811T-50	Tan	Smooth	\$ 75.75
3811C-50	Clear	Smooth	78.48
3811W-50	White	Smooth	77.80

KV 335 SUPPORT

Tan Plastic.

Pin Diameter: 1/4", Pin Length: 7/16", Shelf Rest: 1/2" W x 17/32" L.



Code	Ctn	List/C
335KV	100	\$ 32.13

PLASTIC STANDARDS & CLIPS

Standards

8' Lengths. Standards fit into a 9/16" groove. Order clips separately.

Pack: 10 ea/ctn.

Code	Color	List/ea
63458BR	Brown	\$ 4.88
63458WH	White	4.82

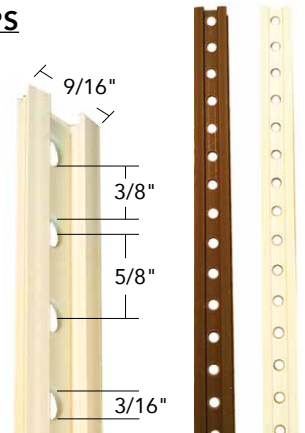

Clips

1/2" Width

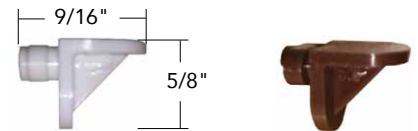

Used with the above standards. Shafts are designed with wings. Clip is inserted on its side into the hole & then turned 90°. Wings lock against the inside of the rail flanges to insure a perfect hold.

Code	Color	Ctn	List/C
25492AL	Almond	100	\$ 12.25
25492BR	Brown	100	13.24
25492WH	White	100	13.24

CLEAR PLASTIC SUPPORTS

Lightweight.
Pin Dia: 1/4"
Shank: 3/8"



169-BN-1075

Code	Ctn	List/C
169-BN-1075	100	\$ 8.85

EARTHQUAKE CLIPS

EARTHQUAKE-PROOF SHELF SUPPORT

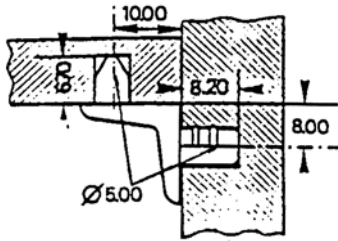

02.7875.104

The two 5mm posts on nickel plated Zamac shelf support keep shelves from sliding in the event of an earthquake.

Code	Ctn	List/C
02.7875.104	100 ea.	\$ 15.86

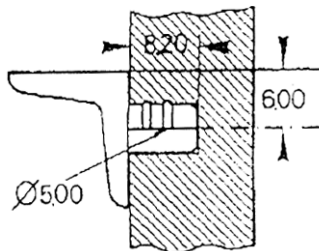

02.7879.104

Non-Seismic Version

Nickel plated with one 5mm peg.

Code	Ctn	List/C
02.7879.104	100 ea.	\$ 17.56

EARTHQUAKE SHELF SUPPORT WITH CLAMP

White Plastic with a 5mm pin.

For Shelf Thickness of 19mm.

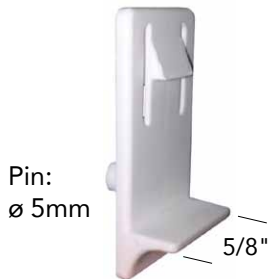

PH341180

Code	Ctn	List/C
PH341180	100 ea.	\$ 10.59

EARTHQUAKE CLIPS

Load Rating: 80 lbs. Pin Diameter: 5mm, Pin Length: 8mm. Overall: 2-1/4" L x 3/4" W Pack: 2500 each



Code	Shelf	Color	List
50536	5/8"	Clear	\$ 13.56/C
50531	5/8"	White	83.13/M
50631-5MM	3/4"	White	101.01
50636	3/4"	Clear	134.19

#55536 -- Clear



Load Rating: 500 lbs. Double pins are 5mm dia x 10mm L C to C = 32mm Overall: 2-1/4" L x 1" W For 3/4" or 1" shelves.

55536

Code	Ctn	List/ea
55536	1250 ea.	\$.57

#55036-0 -- Clear



Load Rating: 300 lbs. Double pins are 5mm dia x 10mm L C to C = 32mm Overall: 2-3/8" L x 1" W For 3/4" or 1" shelves.

55036-0

Code	Ctn	List/ea
55036-0	1250 ea.	\$.31

HETTICH SHELF SECURING STUD

With pivot for 5mm (3/16") holes. Made of translucent plastic.

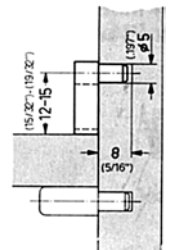

Code	Ctn	List/C
1005082	1000	\$ 7.59

SHELF SUPPORTS

REV-A-SHELF LOCKING SHELF CLIP



Height: 2-1/4"
Depth: 5/16"

Available for 3/4" (305-34)
and 5/8" (305-58) shelves.

5mm pins.

Polymer locking shelf clip with 5mm pin.
Pack: 100 each, full cartons only.

Code	Size	Finish	List/C
305-34-0010-1	3/4"	White	\$ 17.12
305-34-0020-1	3/4"	Clear	17.39
305-58-0010-1	5/8"	White	14.56
305-58-0020-1	5/8"	Clear	16.02

LOCKING SHELF SUPPORTS

Locking shelf support with
2 each 5mm pins.
White in color.



3227W - 3/4"
3228W - 1"

Pack: 2500/Ctn.

Code	Shelf	C/C of stems	List/C
3227W-50	3/4"	1-1/4"	\$ 52.02
3228W-50	1"	1-1/4"	48.79

Locking shelf support in
5mm or 1/4" dia. pins.
White in color.



3226W - 5mm
3236W - 1/4"

Pack: 1000/Ctn.

Code	Shelf	Pin	List/M
3226W-30	3/4"	5mm	\$ 101.89
3236W-30	3/4"	1/4"	91.30

SHELF SUPPORTS FOR GLASS SHELVES

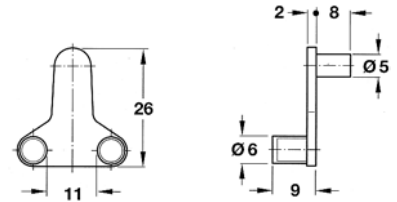

282.23.716

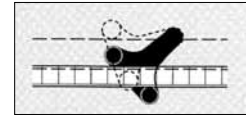

These shelf clamp supports are for glass shelves from 6-10mm thick. Mount glass on top of or between the two projecting supports. Clamping pins have a plastic coating. Shelf pin fits a 5mm hole. Zinc die-cast, nickel plated.

Code	Description	Ctn	List/ea
282.23.716	Glass Shelf Support	10 ea.	\$ 1.75

SHELF PINS



#1401

Duplo Pin
5mm x 16mm

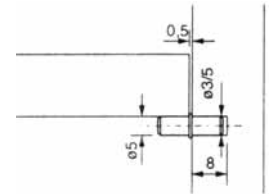

#1402

Straight Pin
5mm x 24mm

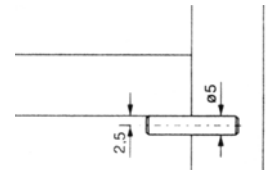

Code	Description	Ctn	List/C
1401ZN	Duplo Pin, Zinc	100 ea.	\$ 4.55
1401PB	Duplo Pin, Pol. Brass	100	3.96
1402BN	Straight Pin, Nickel	100	5.01



SUPPORT BRACKETS

WORK STATION SUPPORT BRACKETS

For Countertops, Desktops and Table Supports



- 1000 lb Load
- 11 Gauge Steel (1/8" thick)
- Weight Limit Exceeds 1000 lbs/pr.
- 1-1/2" Forms with 1/4" Holes
- Two Colors, Five Sizes



Code	Size	Color	Ctn	List/pr
812BL	8" x 12"	Black	5 pr.	\$ 28.40
812WH	8" x 12"	White	5	28.40
1218BL	12" x 18"	Black	3	38.49
1218WH	12" x 18"	White	3	38.49
1521BL	15" x 21"	Black	3	43.45
1521WH	15" x 21"	White	3	44.76
1824BL	18" x 24"	Black	3	62.64
1824WH	18" x 24"	White	3	60.82
2429BL	24" x 29"	Black	2	89.80
2429WH	24" x 29"	White	2	89.80

KV HEAVY DUTY SHELF BRACKET

208WH



Holds up to 1000 lbs/pr.

Holds up to 1000 lbs. per pair when mounted per manufacturer recommendations. 5mm thick steel bar construction. White epoxy coated finish. Recommended fasteners (not included) are 3" or longer x 5/16" lag screws mounted into studs. Attach shelf using a #8 or larger round-head wood screw.

Code	Height x Length	Ctn	List/ea
208WH300	8.3 x 11.6"	10 ea.	\$ 9.03
208WH400	10.6 x 16.6"	10	10.69
208WH500	12.9 x 19.5"	10	13.02
208WH550	14.2 x 21.7"	10	15.74

CONCEALED WORK STATION BRACKETS

Mount to stud for extra strength

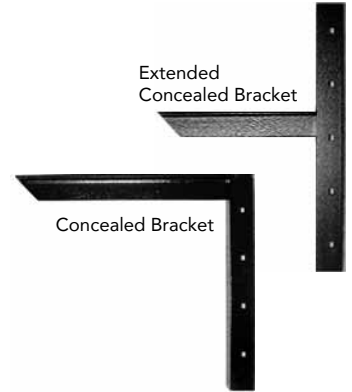
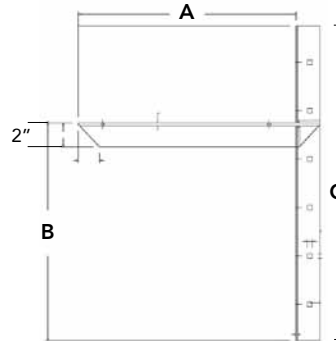

- Steel Construction
- Load limit range of 1,800 to 4,500 lbs. per pair
- Mounting hardware included
- All welds on reverse for easy, clean install
- Black in Color



This Island was made using Extended Concealed and Concealed brackets



Extended Concealed brackets used to create a floating shelf.



This picture shows the installation of the Extended Concealed Bracket behind drywall and how it looks when the drywall is installed overtop

Code	A	B	C	Weight Cap / pr.	List/ea
C18-BL	18"	18"	-	2,060	\$ 69.15
C24-BL	24"	18"	-	1,800	77.49
EC-18BL	18"	18"	26"	4,500	84.23
EC-24BL	24"	18"	26"	2,320	91.81

SUPPORT BRACKETS

SPEEDBRACE "STEALTH"

FastCap



Nearly invisible when installed



12" & 16" mounted on pony wall

24" mounted on double bracing

The Stealth Speedbrace supports your countertop and bar overhangs with no visible kicker or expensive corbels. A pair of braces will support 300 lbs. of weight. Sold individually.

Features

- 3/16" Steel, 3-1/2" wide
- Black Finish
- Countersunk screwholes

Great For:

- Countertops
- Bars
- Extra Bracing

Code	Description	List/ea
SB-12BL	12" Black Speedbrace	\$ 16.18
SB-16BL	16" Black Speedbrace	20.22
SB-24BL	24" Black Speedbrace	26.29

SPEEDBRACE "STEALTH" HD

Heavy Duty

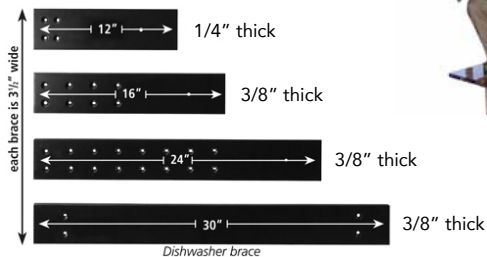

Heavy duty version of above Speedbrace. A pair of HD braces will support 500 lbs. of weight. 12" is 1/4" thick. 16", 24" and 30" are 3/8" thick. All 3-1/2" wide. Black finish. Sold individually.

Code	Description	List/ea
SB-12HD	12" Heavy Duty Speedbrace	\$ 14.56
SB-16HD	16" Heavy Duty Speedbrace	28.31
SB-24HD	24" Heavy Duty Speedbrace	38.82
SB-30HD	30" Heavy Duty Speedbrace	56.87

FOLDING SHELF BRACKETS

KV 206 FOLDING L-BRACKET

Heavy Duty

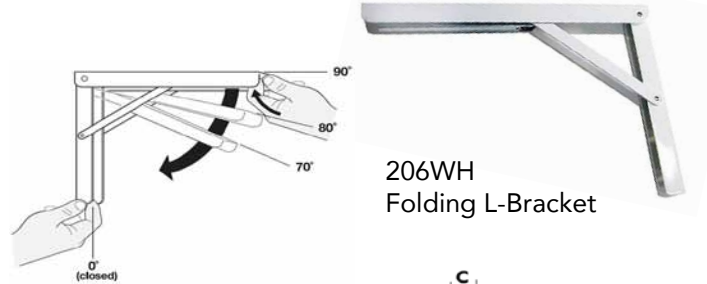

206WH
Folding L-Bracket

Dimensions:

Size	A	B	C
12"	11.8"	7.9"	.6"
16"	15.75"	10.6"	.8"

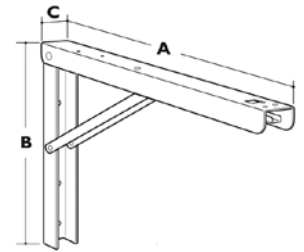

- For 12" to 24" Deep shelving
- Can be mounted to any type of wall
- Adjustable to 4 positons: 90°, 80°, 70°, and 0° (closed position)
- Durable zinc-coated steel construction with spring-loaded release lever
- Exceeds BHMA static load testing requirements
- Load Rating: 12" - Up to 770 lbs/pr
16" - Up to 880 lbs/pr

These sturdy folding L-brackets allow you to create a worksurface that can be quickly folded out of the way when no longer needed. The KV 206 bracket's convenient one-hand release mechanism makes the bracket easy-to-open, close, or adjust without the danger of getting hands caught in a folding crossbar.

Code	Description	Ctn	List/ea
206WH12	12" White Folding Brkt	10	\$ 24.65
206WH16	16" White Folding Brkt	10	34.99

FOLDING SHELF BRACKETS

FOLDING SHELF BRACKET

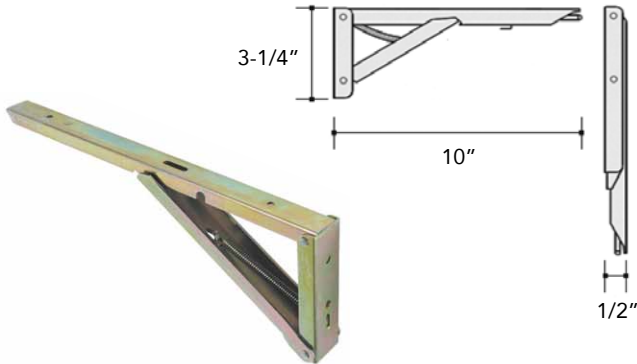

Hinged spring brackets are especially suitable for extending tables or worktops. Locks into upright position automatically. Light pressure on release button allows fold-down positioning. Steel, yellow chromated finish. 88 lbs per pair weight capacity. Use 2 each #10 and 3 each #6 panhead screws (not provided) to install.

Pack: 10/Ctn.

Code	Description	List/ea
FT65795	10" Steel Folding Shelf Bracket	\$ 15.29

FOLDING SHELF BRACKET

Parker



This folding steel shelf bracket is ideal for folding tables, work surfaces, book shelves or anywhere a foldaway shelf is required. 110 lb. load rating per pair.

Locks automatically in open position. Gray baked enamel finish.

Code	Size	Ctn	List/pr
1794-8	8" x 8"	12 pr.	\$ 14.64
1794-12	12" x 12"	6	22.93
1794-16	16" x 16"	6	27.67

SHELF BRACKETS

SUGATSUNE FOLDING BRACKET

Stainless Steel

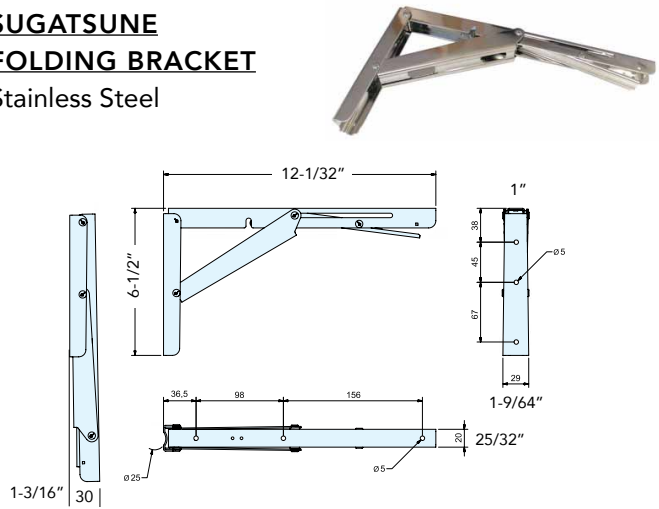

- Automatically locks when flap is in opened position
- Depress lever to release the lock
- Bracket with hinge function in one unit

Code	Finish	Load cap	Ctn	List/ea
EB-303EP	Pol. Stainless Steel	330 lbs.	25	\$ 41.19

KV 204 NON-ADJUSTABLE SHELF BRACKET

A basic reinforced L-Bracket ideal for garages, basements, workshops or anywhere heavy duty shelving is needed.



Wrought Steel, Anachrome finish. Screws included.

Code	Size	Ctn	List/ea
204-8	8"	24 ea.	\$ 6.83
204-10	10"	24	7.79
204-12	12"	24	7.99

NON-ADJUSTABLE SHELF BRACKET

Parker

Gray enamel finish, 24 each/box. Screws not included.



Code	Size	Ctn	List/ea
1785	5" x 6"	24 ea.	\$ 1.27
1788	8" x 10"	24	1.78
1792	12" x 14"	24	3.87

FLOATING SHELF BRACKETS

FLOATING SHELF BRACKET

FS-BR

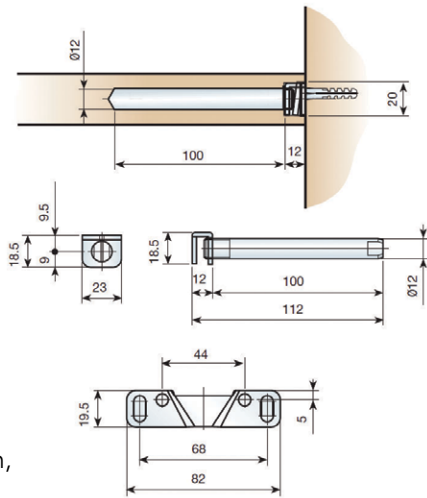

Up to 8" Shelf Depth,
Load Cap: 37.4 lbs.
per pair of brackets*

Up to 12" Shelf Depth,
Load Cap: 25.3 lbs.
per pair of brackets*

* Based on 35" Length shelf with 2 brackets.

For every 18" additional length, add 1 additional bracket.

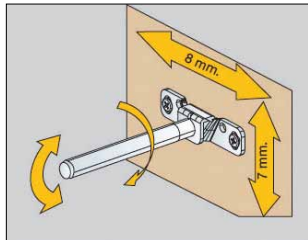

Oval holes allow accurate leveling. It can be horizontally adjusted +/- 5° by moving the rod along the support.

The 90° angle may be easily adjusted +/- 5° just by turning the rod.

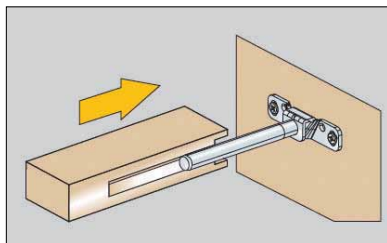

Place the shelf in position. This can subsequently be removed whenever necessary to carry out further adjustments.

Each bag contains:

1 support, 4 plastic wall plugs, and 4 screws.

Code	Description	Ctn	List/bg
FS-BR	Floating Shelf Bracket	25 bgs.	\$ 8.99

FLOATING SHELVES - All Special Order

Omega National



Decorative,
Functional
and Elegant



- Use between cabinets, at the end of a cabinet run, or free-standing in the kitchen, bath or other area of the home
- Turn-key system includes floating shelf, hanging brackets, hardware for mounting and instructions
- Supports 15 lbs. per running foot of shelf length, exceeding KCMA requirements
- 5 widths offered: 24", 30", 36", 42" and 48"
- Shelves are 2-1/2" Thk x 10" D - can trim to 2" min depth
- Offered in ready-to-finish maple, cherry, alder, paint grade, red oak and hickory
- Solid wood and wood veneer construction (paint grade is poplar and mdf)
- Made in the USA

24", 30", 36", 42", 48"

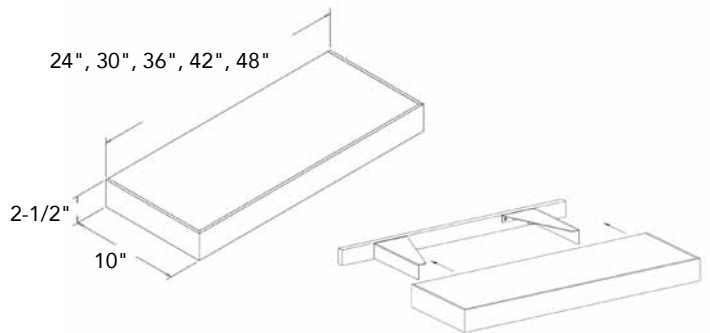

Specify Finish:

MUF (Maple), XUF (Paint Grade), CUF (Cherry), OUF (Red Oak), HUF (Hickory), QUF (Alder)

Code	Height x Depth x Length	List*
FS0124	2.5" x 10" x 24"	\$ 102 - 145
FS0130	2.5" x 10" x 30"	108 - 161
FS0136	2.5" x 10" x 36"	120 - 191
FS0142	2.5" x 10" x 42"	125 - 198
FS0148	2.5" x 10" x 48"	125 - 202

* Depending on finish specified

All Special Order



SUPPORT BRACKETS

OMEGA SUPPORT BRACKETS

Pack: 2 brackets, Full Cartons Only

S1101 Support Bracket

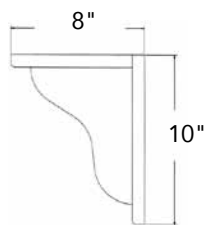

Code	Description	List/ea
S1101MUF2	Maple	\$ 22.89
S1101CUF2	Cherry	26.91
S1101QUF2	Alder	21.98
S1101OUF2	Red Oak	21.96

S1102 Support Bracket

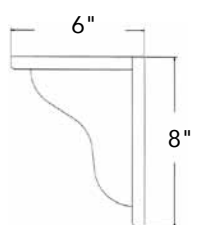

Code	Description	List/ea
S1102MUF2	Maple	\$ 21.94
S1102CUF2	Cherry	25.98
S1102QUF2	Alder	20.77
S1102OUF2	Red Oak	21.10

OMEGA CARVED ONLAYS



Grape Applique
CAG01



Code	Specie	List/ea
CAG01RUF1	Rubberwood	\$ 59.07



For more carved onlays
see pages 1108-1111

CLASSIC CORBELS

Ornamental Moulding

Maple Wood.
5-11/16" x 4-13/16" x 10"



Code	Ctn	List/ea
CA8	2 ea.	\$ 74.52

14

OMEGA CARVED CORBELS

OMEGA CARVED CORBELS

Unfinished Wood, Carved & Sanded. Choice of five wood species. All one each per box.

Scroll Corbel Carving

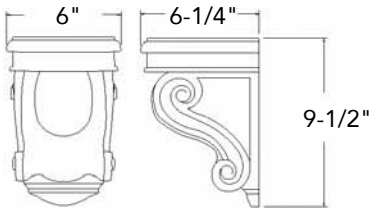

Code	Description	List/ea
CCS0203QUF1	Alder	\$ 153.86
CCS0203RUF1	Rubberwood	103.73

Scroll Corbel Carving - Open

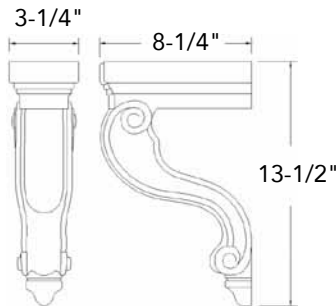

Code	Description	List/ea
CCS0503MUF1	Maple	\$ 185.27
CCS0503CUF1	Cherry	220.70
CCS0503QUF1	Alder	185.27
CCS0503RUF1	Rubberwood	141.32

Scroll Corbel Carving

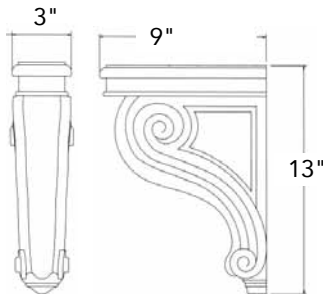

Code	Description	List/ea
CCS0103MUF1	Maple	\$ 129.23
CCS0103CUF1	Cherry	165.92
CCS0103QUF1	Alder	116.76
CCS0103OUF1	Red Oak	122.93
CCS0103RUF1	Rubberwood	92.91

OMEGA CARVED CORBELS continued

Grape Scroll Corbel Carving

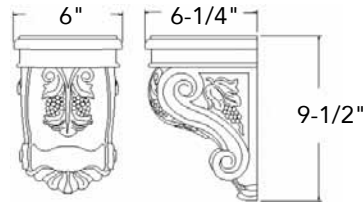

Code	Description	List/ea
CCG0203MUF1	Maple	\$ 153.85
CCG0203CUF1	Cherry	191.43
CCG0203QUF1	Alder	156.72
CCG0203OUF1	Red Oak	153.85

Grape Scroll Corbel Carving - Open

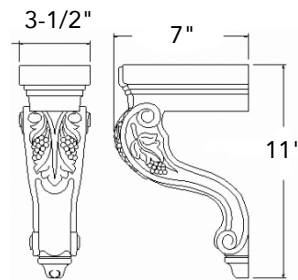

Code	Description	List/ea
CCG0603MUF1	Maple	\$ 155.97
CCG0603CUF1	Cherry	186.11
CCG0603QUF1	Alder	140.63
CCG0603OUF1	Red Oak	155.97

Grape Scroll Corbel Carving

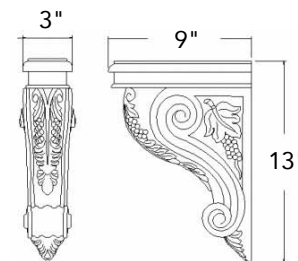

Code	Description	List/ea
CCG0303MUF1	Maple	\$ 158.95
CCG0303CUF1	Cherry	196.53
CCG0303QUF1	Alder	138.92
CCG0303OUF1	Red Oak	153.67



BENDIX CARVED CORBELS

HAND CARVED CORBELS

Large Acanthus Corbel



1996
8-1/4" Deep
13-1/4" High
3-3/4" Wide

Petite Scroll Corbel



2021
1-3/4" Deep
4-1/2" High
3" Wide

Petite Acanthus Corbel



2020
1-3/4" Deep
4-1/2" High
3" Wide

<u>Code</u>	<u>Alder</u>	<u>Bass</u>	<u>Cherry</u>	<u>Maple</u>
1996-	\$ 326	-	\$ 498	-
2021-	-	-	-	\$ 49
2020-	49	41	61	-

Scroll Corbel



1954 Mini
3-3/4" Deep
6-1/2" High
3-1/2" Wide



1955 Small
5-3/4" Deep
9-3/4" High
4-1/2" Wide



1957 Medium
7-1/4" Deep
14" High
5-1/2" Wide

<u>Code</u>	<u>Alder</u>	<u>Bass</u>	<u>Cherry</u>	<u>Maple</u>
1954-	\$ 122	\$ 81	\$ 116	122
1955-	163	126	188	209
1957-	240	193	277	277

HAND CARVED CORBELS

Traditional Corbel



2022
Medium
3" Deep
11" High
5" Wide



2023
Large
3-1/2" Deep
14" High
7" Wide

Deep Traditional Corbel

2024
7-1/2" Deep
12" High
3-1/2" Wide



<u>Code</u>	<u>Bass</u>
2022-B	\$ 104
2023-B	160
2024-B	161

Arts & Crafts Corbel



1931 Small
2-3/4" Deep
6" High
3" Wide



1941 Medium
4" Deep
9" High
6" Wide



1942 Bar
9" Deep
12" High
3-1/2" Wide



1943 Bar
3-1/2" Deep
13" High
3-1/2" Wide

<u>Code</u>	<u>Alder</u>	<u>Bass</u>	<u>Cherry</u>	<u>Maple</u>
1931-	-	\$ 56	-	\$ 84
1941-	-	115	165	-
1942-	210	178	255	255
1943-	-	-	160	-

14

CABINET HANGERS

ALUMINUM HANGING RAILS & CLIPS

Heavy Duty

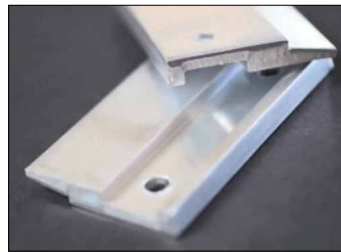
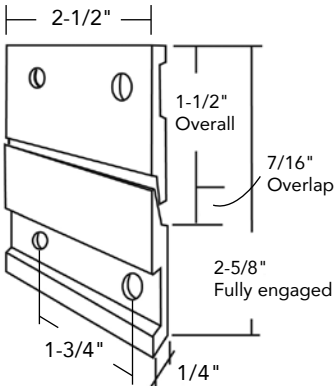

HC2 Clips - 2-1/2" width
Sold per pair

Two interlocked clips shown.

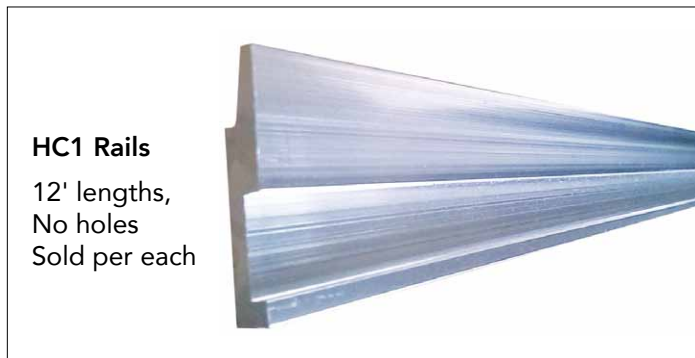

HC1 Rails
12' lengths,
No holes
Sold per each

Excellent for hanging wall panel systems, elevator panels, cabinetry door displays, speaker panels, blind panels, secret panels, etc.

This aluminum extrusion provides a simple, secure and concealed installation. Provides easy panel removal for mechanical access, remodeling or refinishing. Clips are 2-1/2" wide, 1-1/2" high, with holes and sold in pairs. Rails are 144" (12') lengths, without holes and sold per each. Screws not included. Clip can use up to a #10 pan-head screw.

Clips allow slim 1/4" clearance, side to side adjustability and high load capacity.

Code	Description	Ctn	List
HC1	144" (12') Hanging Rail	10 ea.	\$ 46.84/ea
HC2	2-1/2" Hanging Clip	24 pr.	2.61/pr

CAMAR WALL CABINET HANGING SYSTEM

Camar's bracket and rail system simplifies cabinet installation. No shimming is necessary, and adjustment after installation becomes possible. Brackets attach on the inside of each cabinet side panel, allowing the cabinet to be secured to the hanging rail. Load Capacity: 300 lbs. per pair of brackets. Brackets are non-handed.



#875-Z1-24
Wall Mounted Hanging Strip
Galv. Steel. 2.5 meter (8'2")



#802-01-V1
Bracket

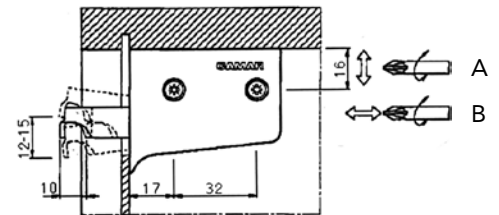
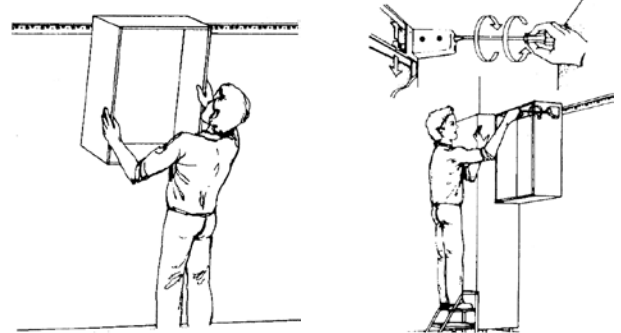

Adjustments:

- Side to side: adjustment unlimited
- Height adjustment: Up or Down 32 mm (1-1/4")
Turn screw -A- clockwise to raise the cabinet and counter clockwise to lower the cabinet
- Depth adjustment: In or out 27 mm (13/16")
Turn screw -B- clockwise to pull the cabinet towards the wall and counter clockwise to move the cabinet away from the wall.

Code	Description	Ctn	List/ea
875-Z1-24	Hanging Strip, Steel	30 ea.	\$ 16.93
802-01-V1	Bracket, Unhanded	100	3.79
883-01-24*	Rail Cover, White, 2.5 meters	30	8.88



TV MOUNT

TV SWIVELS

PEERLESS TELEVISION WALL MOUNT

Single Arm Style Wall Mount

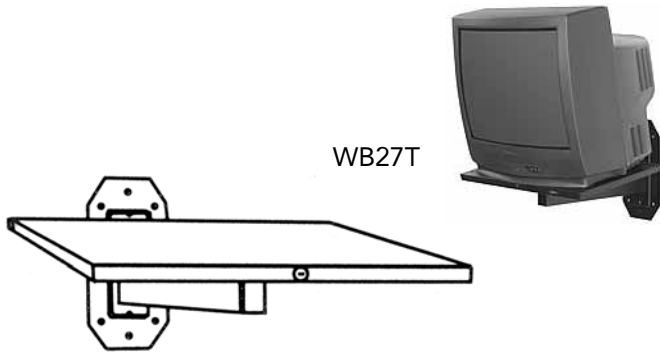

Ideal for corners and tight spots in hospitals, hotels and any area with limited space. Features: Adjustable swivel and fixed 10° forward tilt. Black in color. The WB20T has a rectangular wall arm, the WB27T has a tapered wall arm.

(OSHPD 2001 Calif. State Code approved for seismic safety compliance in hospitals and state structures).

Code	TV Screen	Tray Width	Tray Depth	Reach*	List
WB27T	25" - 27"	25"	10"	23"	\$ 159.96

* From wall to front edge of tray.

ALUMINUM TV SWIVEL WITH BALLBEARINGS

Diameter: 18" or 24"
Very smooth.



Code	Diameter	Load Cap	List/ea
54450	18"	330 lbs	\$ 124.26
54600	24"	660	309.17

KV 1388 HEAVY DUTY TV SWIVEL (Old No. 3620-258)

Load Capacity: 225 lbs.
Full Extension

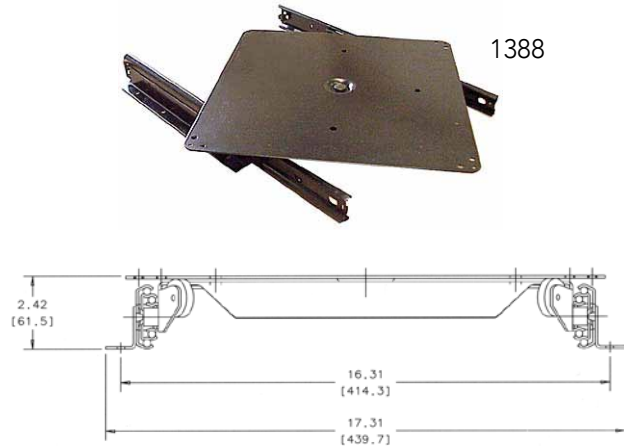

Load Capacity: 225 lbs.

Metal plate is 16" x 16" and can accommodate a wooden platform to match cabinet interior. Accommodates up to 36" diagonal TV. Hold-in detent prevents accidental pull-out. 360° swivel action allows optimum viewing angle.

Black finish. Telescopic action.
Dimensions: 17-5/16" wide x 2-7/16" high.
Slide length: 15-1/2", Slide Travel: 14"
Plate: 16" x 16", Plate Diagonal: 22"

Code	Description	List/ea
1388	TV Swivel, 225 lbs.	\$ 155.44

Note: Mounting hole locations, plate size, load capacity, slide length and travel match the 3620-258 TV swivel exactly.



FLAT SCREEN TV LIFTS

INCA PLASMA LIFT

Load Capacity: 200 lbs.

"Advantage Plus" Series
Available with or without an
automatic swivel platform.

Accommodates 42" to 50"
plasma screens from any
manufacturer. New super-
stable silent drive system.
Radio remote control included.



900828-1B 42"
Plasma Lift



900828-1SB 42"
Lift with Automatic Swivel

Specifically designed to meet the needs of furniture manufacturers and cabinetmakers, the Advantage Plus is easy to order and easy to install. For most 42" or 50" TVs, the lift comes "knock down" to save on shipping costs.

Features:

- Includes radio frequency remote control
- On board power receptacle & external J-Box
- Override switch for manual system operation
- Low cost, efficient, and reliable
- Limited 2 year manufacturer's warranty
- Includes universal TV mounting frame to permit easy installation of any manufacturer's plasma screen up to 50" in width
- Load Capacity: 200 lbs.

All Special Order.

Load Capacity: 200 lbs.

Code	Overall Dimensions	Max TV Height	Max Cab Height	Moving Platform	Swivel	Travel	List
900828-1B	50.75" W x 5" D x 35.875" H	27.875"	30.875"	48.125" W x 3.75" D	No	30.875"	\$ 4528
900828-1SB	50.75" W x 5" D x 37.875" H	28.375"	31.375"	48.125" W x 3.75" D	Yes	31.375"	6004
900828-2B	56" W x 8.5" D x 38" H	31.25"	34.75"	53.375" W x 8.125" D	No	34.25"	4321
900828-2SB	56" W x 8.5" D x 40" H	31.75"	34.75"	53.375" W x 8.125" D	Yes	34.75"	6012

TV LIFTS

WHISPER RIDE VERSALIFT

For 10" to 26" Flat TVs



WR-VL

For 10" to 26" TVs



Features

- The remote control lift designed for multiple applications
- Perfect for raising and lowering TVs, desk monitors and cabinet shelves
- Ideal for limited space applications in boats, RVs, footboards, end tables and flat mounted in base cabinets
- Weight capacity 110 lbs.
- 18" of travel, 1.1"/sec
- Accommodates TVs/monitors up to 26"
- UL listed power supply 

Complete inside one carton:

Code WR-VL List \$ 758.25

- Remote control (RF)
- Manual push switch
- Plug and play assembly
- Universal TV mounting bracket

FLAT SCREEN TV LIFT Whisper Ride™

Takes Flat Screen TVs up to 48"



4050WR

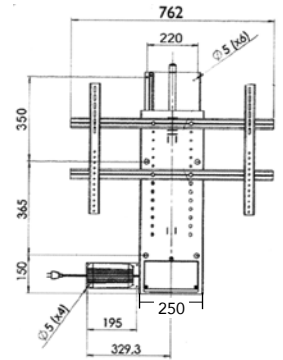

Total Travel: 29.5"

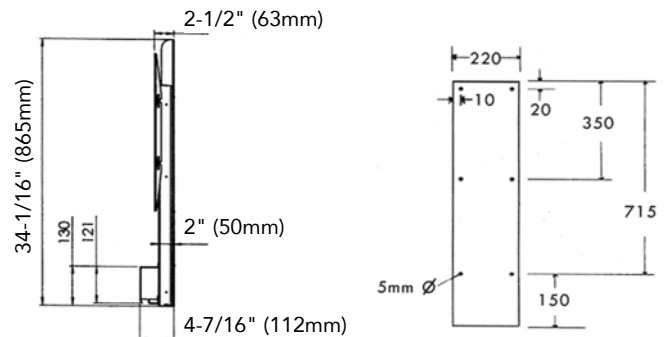

Overall Extended Height: 58-1/8"
Unit Weight: 40 lbs.

Min. Height closed: 34-1/16"

Back Panel Mounting Holes

Weight Capacity:
200 lbs.

"Whisper Quiet" Operation

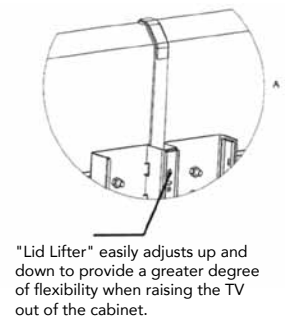
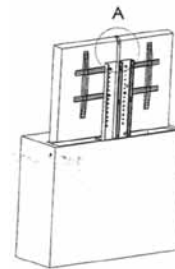

"Lid Lifter" easily adjusts up and down to provide a greater degree of flexibility when raising the TV out of the cabinet.

- High quality German Bosch motor for whisper quiet operation
- Ball-bearing guide system for added stability
- Requires only 2-3/4" of depth behind the TV
- Weight Capacity of 200 lbs.
- Can be easily mounted by one person in minutes using only a screwdriver
- Radio command remote control with manual override switch included.
- UL Listed, 34-1/16" Closed Ht.

<u>Code</u>	<u>Description</u>	<u>List/ea</u>
4050WR	Flat Screen TV Lift	\$ 1139

TV LIFTS

WHISPER RIDE 700

For 26" to 42" Flat TVs



WR700
For 26" to 42" TVs

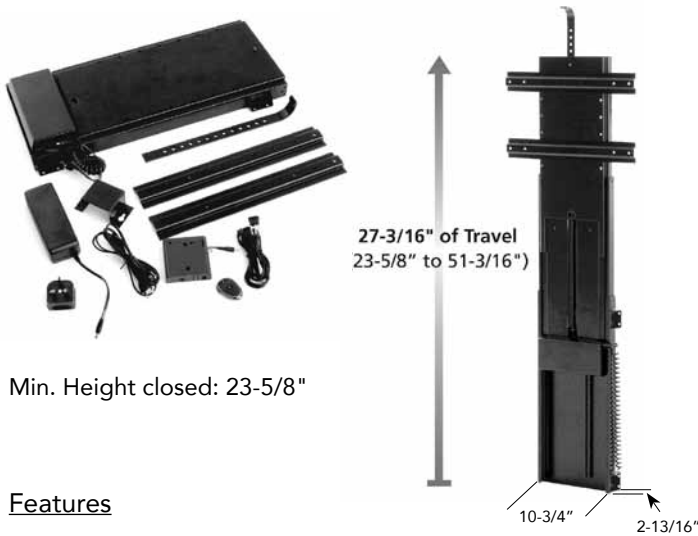

Min. Height closed: 23-5/8"

Features

- Quiet operation
- Rack and pinion design with unique stability system
- Requires only 2-13/16" depth behind the TV
- Weight capacity 220 lbs.
- 27-3/16" of travel
- Simple and fast mounting
- Adjustable stroke height / stroke drop
- UL listed power supply 

Complete inside one carton:

- Remote control (RF)
- Manual push switch
- Adjustable lid lifter
- Plug and play assembly
- Universal TV mounting bracket

Code	List
WR700	\$ 1267.77

WHISPER RIDE 1000

For 50" to 70" Flat TVs



WR1000
For 50" to 70" TVs

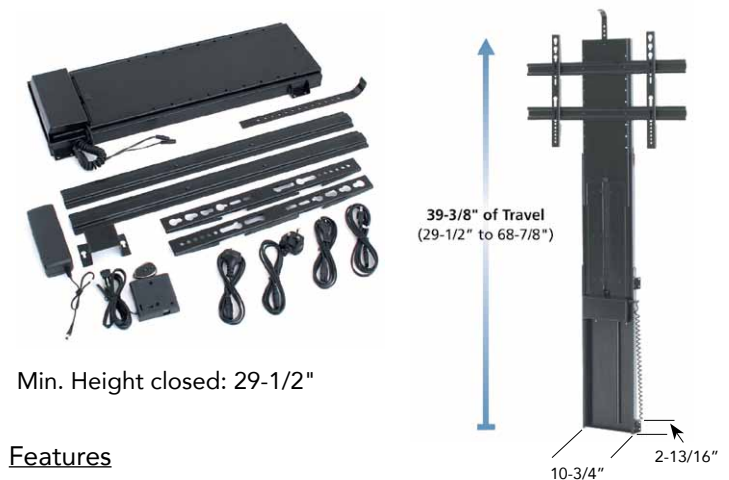

Min. Height closed: 29-1/2"

Features

- Quiet operation, 1.1"/sec
- Rack and pinion design with unique stability system
- Reverse safety function
- Requires only 2-13/16" depth behind the TV
- Weight capacity 225 lbs.
- 39-3/8" of travel
- Simple and fast mounting
- IR remote available
- Anti-pinch safety protection
- UL listed power supply 

Complete inside one carton:

- Remote control (RF)
- Manual push switch
- Adjustable lid lifter
- Plug and play assembly
- Universal TV mounting bracket

Code	List
WR1000	\$ 1541.80



ELEMENT DESIGNS Aluminum Frame Cabinet Doors



- Doors ship fully assembled
- Quick delivery
- 1/16" increments (H x W)
- Tempered safety glass
- No minimum orders
- Made in the USA
- Multiple glass types available

All Special Order:

4 weeks of production,
1 week of shipping.

Expedited service available:
2 weeks of production.

Profile Finishes

- Natural Aluminum
- Brushed Stainless
- Chrome-Look (certain profiles only)
- Arctic Gold (certain profiles only)
- Powder Coat:
 - Black
 - White
 - Oil Rubbed Bronze

Frame Profiles 4mm inserts except where noted

AF001

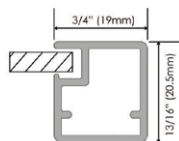

AF002

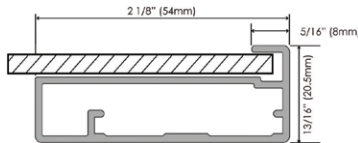

AF003

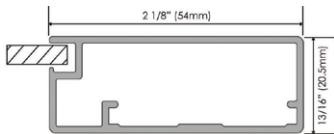

AF004

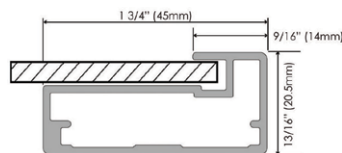

AF005

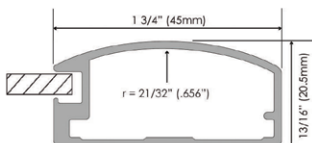

AF006

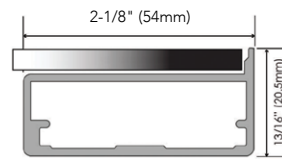

AF006 is only available with opaque backpainted glass inserts which are permanently adhered to frame.

AF007

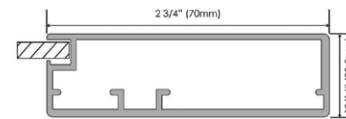

AF008

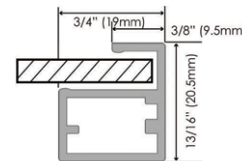

AF009 - 6mm Insert

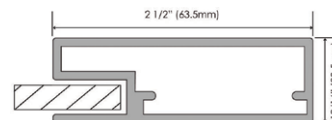

AF009 is only available with 1/4" satin and clear glass

AF010

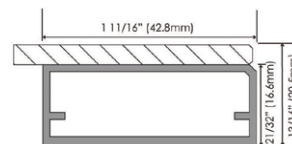

AF010 is only available with backpainted glass or parapan inserts which are permanently adhered to frame.

AF011





ELEMENT DESIGNS Aluminum Frame Cabinet Doors cont.



Smoked Glass Inserts



AF002 Profile in Brushed Stainless Steel Look Finish with Satin Glass.

Standard Glass Insert Options

- All glass is tempered safety glass
- Glass inserts are 5/32" (4mm) thick
- Assembled doors without inserts also available
- Etched and patterned side faces into cabinet unless otherwise specified
- Low iron backpainted glass inserts available (see element-designs.com for color options)
- High Gloss Parapan inserts available - see page 1424 for color options



Metallic Insert Options

- Double sided metal laminate with hardboard core (Aluminum and Brushed Stainless only)
- Inserts are 5/32" (4mm) thick

Note: Platinum Ice is Acrylic with a Metallic Sheen. Not available with AF006.



AF003, natural aluminum finish, and platinum ice acrylic inserts.

Architectural Resin Inserts



- Inserts are 5/32" (4mm) thick
- Sandstone finish on front and back
- Contain organic materials and may vary in color and density due to natural conditions

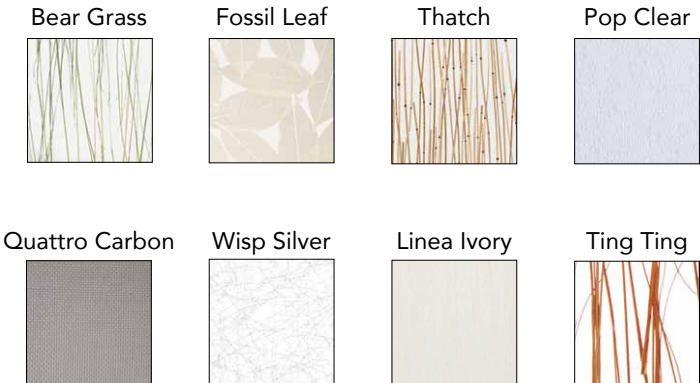



www.element-designs.com

Aluminum Frame Doors

Quote Order

Company: _____
 Contact Name: _____
 Address: _____
 City / State / Zip: _____
 Phone #: _____
 Fax #: _____
 Email: _____

Email Form to orders@macmurraypacific.com
 Fax to (415) 552-5840

**MACMURRAY
 PACIFIC**



568 7th St. San Francisco, CA 94103 (415) 552-5500

Date: _____ PO #: _____
 Project Name: _____
 Project Location: _____

1 Profile Type

- AF001** AF002
- AF003 AF004
- AF005 AF006*
- AF007 AF008**
- AF009 AF010*
- AF011

*AF006 & AF010 available ONLY with opaque Backpainted Glass inserts

** AF001 & AF008 are Narrow Profiles. Hinge fabrication must be done by Element Designs. **MAX 48" H or W**

2 Profile Finish

- Anodized Finish
 - Natural Anodized
 - Brushed Stainless
 - Chrome (AF003 & AF010 ONLY)
 - Arctic Gold (AF003 ONLY)
- Powder Coat Finish
 - Oil Rubbed Bronze
 - White Black

3 Insert Type (select one) all inserts are 5/32" (4mm)

- Standard Glass Inserts:
 - Satin (Acid Etched) Lustral D Reeded (Vertical)
 - Clear Austral Reeded (Horizontal)
 - Smoked Grey Master Carre
 - Low-Iron Clear Low-Iron Satin (Acid Etched)

• Backpainted Glass Inserts:

Finish (select one): Gloss Matte

Paint Color (select one):

- White Scarlett Silver
- Black Olive Bronze
- Sand Mocha Charcoal
- Non-Standard Color: _____
- Custom Color*: _____

*Custom Color match approval & fee applies. Contact Element Designs for details.
 **Backpainted glass has a light gray backer, unless otherwise specified

• 3form® Resin Inserts:

Pattern: _____

• PARAPAN® High Gloss Inserts:

Color: _____

• Metallic Inserts:

- Aluminum Laminate Stainless Lam. (Vertical)
- Platinum Ice Acrylic Stainless Lam. (Horizontal)

• Custom Etch: Positive Negative

*Art work must be supplied, subject to set up fee. Contact Element Designs for details.
 All glass is tempered safety glass & will not have etched tempered logo unless otherwise specified at time of order. Refer to local building codes.

NO INSERT

4 Hinge Hardware Selection

Wide Frame:

- QTY: _____
 Full Overlay (35mm cup)
 Soft Close (71B3550)
 Self Close (71T5550)
 Free Swing (70T3580)

Half Overlay (35mm cup)

- Soft Close (71B3650)
 Self Close (71T5650)
 Free Swing (70T3650)

Narrow Frame*:

*ONLY AF001 & AF008

- QTY: _____
 Full Overlay (Narrow)
 15mm Soft Close (71B950A)
 15mm Self Close (73T550A)
 17mm Self Close (71T950A)
 19mm Self Close (C2Z6A99)
 15mm Free Swing (72T550A)

Half Overlay (Narrow)

- Soft Close (71B960A)
 Self Close (71T560A)

Hinge Mounting Plates: QTY: _____

- 0mm Do not include mounting plates

Include Tip On Hardware: Yes QTY: _____

5 Decorative Hardware & Handles

Drill for handle holes (Must specify handle location on pg 2)

Natural Anodized		Brushed Stainless & ORB	Various Finishes
Knobs	Bar Pulls	Bar Pulls	Finger Pulls
<input type="checkbox"/> K001	<input type="checkbox"/> P1-127	<input type="checkbox"/> P1-76S	<input type="checkbox"/> P2-42
<input type="checkbox"/> K005	<input type="checkbox"/> P1-190	<input type="checkbox"/> P1-192S	<input type="checkbox"/> P2-42S
<input type="checkbox"/> K006	<input type="checkbox"/> P1-250	<input type="checkbox"/> P1-320S	<input type="checkbox"/> P2-42ORB
<input type="checkbox"/> K007	<input type="checkbox"/> P1-380	<input type="checkbox"/> P1-76ORB	
<input type="checkbox"/> K008	<input type="checkbox"/> P1-640	<input type="checkbox"/> P1-192ORB	
<input type="checkbox"/> K009	<input type="checkbox"/> P1-880	<input type="checkbox"/> P1-320ORB	<input type="checkbox"/> Other

QTY: _____

Item	Qty	Dimensions		in or mm	Left (L)	Right (R)	Up (U)	Drawer (D)	Panel (P)	# Hinge Bore per Door	Element Designs Use Only	
		Width	Height								Price	Ext. Price
1					<input type="checkbox"/> L	<input type="checkbox"/> R	<input type="checkbox"/> U	<input type="checkbox"/> D	<input type="checkbox"/> P			
2					<input type="checkbox"/> L	<input type="checkbox"/> R	<input type="checkbox"/> U	<input type="checkbox"/> D	<input type="checkbox"/> P			
3					<input type="checkbox"/> L	<input type="checkbox"/> R	<input type="checkbox"/> U	<input type="checkbox"/> D	<input type="checkbox"/> P			
4					<input type="checkbox"/> L	<input type="checkbox"/> R	<input type="checkbox"/> U	<input type="checkbox"/> D	<input type="checkbox"/> P			
5					<input type="checkbox"/> L	<input type="checkbox"/> R	<input type="checkbox"/> U	<input type="checkbox"/> D	<input type="checkbox"/> P			
6					<input type="checkbox"/> L	<input type="checkbox"/> R	<input type="checkbox"/> U	<input type="checkbox"/> D	<input type="checkbox"/> P			
7					<input type="checkbox"/> L	<input type="checkbox"/> R	<input type="checkbox"/> U	<input type="checkbox"/> D	<input type="checkbox"/> P			
8					<input type="checkbox"/> L	<input type="checkbox"/> R	<input type="checkbox"/> U	<input type="checkbox"/> D	<input type="checkbox"/> P			
9					<input type="checkbox"/> L	<input type="checkbox"/> R	<input type="checkbox"/> U	<input type="checkbox"/> D	<input type="checkbox"/> P			
10					<input type="checkbox"/> L	<input type="checkbox"/> R	<input type="checkbox"/> U	<input type="checkbox"/> D	<input type="checkbox"/> P			
11					<input type="checkbox"/> L	<input type="checkbox"/> R	<input type="checkbox"/> U	<input type="checkbox"/> D	<input type="checkbox"/> P			
12					<input type="checkbox"/> L	<input type="checkbox"/> R	<input type="checkbox"/> U	<input type="checkbox"/> D	<input type="checkbox"/> P			

Special Instructions:

Knobs/Pulls:	
Hardware:	
Shipping:	
TOTAL:	



ELEMENT DESIGNS Backpainted Glass



Element Designs offers backpainted glass for both commercial and residential applications. Custom backpainted glass thicknesses include 4mm (5/32"), 6mm (1/4"), 10mm (3/8") and 12mm (1/2") in either a gloss or matte finish. Backpainted glass is an ideal product for a variety of applications such as wall panels, partitions, back-splashes, table tops, countertops and even trade show flooring. The durability of glass combined with vibrant color result in beautiful surface materials for any application. There are nine standard colors, 177 non-standard colors and full custom color matching capabilities.

Non-Standard Colors

Available in 177 non-standard colors: visit element-designs.com for full spectrum.

Custom Colors

Element Designs can provide exact color matches for custom projects. A custom color match fee covers the paint matching process and two 12" x 12" samples for approval. Samples of non-standard colors can also be obtained for a fee.

Standard Colors



Edge Finish Options

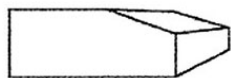

Bevel

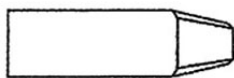

Flat Edge Polish

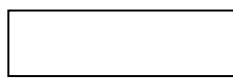

Seamed
(concealed edge applications)

Please refer to Design Guidelines at element-designs.com for Edge finish availability for specific thicknesses. Backpainted glass can be fabricated to include notches, cut-outs, holes and custom shapes.

GOLA Aluminum Spacer Channels

Achieve sleek, hardware-free cabinetry without additional fabrication to cabinet doors or drawer fronts. The spacer channels provide ample space for fingertips so that the actual drawers and door fronts can be used to open and close instead of exposed handles or pulls. The numerous finish options accent or blend into most cabinetry applications. Cut-to-size profiles available to make your installation easier.



J-Shaped Horizontal channel in White finish.

Horizontal and Vertical Profiles available in various lengths and finishes.

GC-8006 J-Shaped channel:
Install under countertop

GC-8007 C-Shaped channel:
Install between drawer fronts

GC-1730 Upper cabinet channel:
Upper cabinet installation

See element-designs.com for more info.



ELEMENT DESIGNS PARAPAN Solid Surface Doors



















Element Designs is proud to offer PARAPAN high gloss, solid surface doors and inserts. Used by the leading European luxury cabinet manufacturers, PARAPAN is a revolutionary material engineered to be durable and environmentally friendly - no VOCs.

The PARAPAN material creates highly reflective doors and surfaces ideal for the most discriminating residential and commercial interiors. Both front and back surfaces yield a perfect flat mirror finish. Unlike other high gloss finish doors, minor scratches can be removed through buffing and polishing as a result of the high quality solid surface composition. UV and fade resistant. Doors arrive fully fabricated and ready to install.

Available in 2 distinctive styles: 18mm solid doors and aluminum frame doors with 4mm inserts. 18mm doors available with a choice of two standard integrated pull options.



Color Options

								
alpine white 5910	white 5907	opal white 5196	latte 5772	pale ivory 5525	light grey 5290	stone grey 5295	cappuccino 5773	mint 5421
								
kiwi 5440	turquoise 5471	cobalt blue 5380	orange 5570	bordeaux 5600	signal red 5655	oxide red 5771	brown 5776	black 5299

 anthracite 5297
only available in
18mm thickness





18mm Parapan Door & Drawer Front Finishing Options

- All edges, front and back have high gloss finish
- Functional/decorative hardware borings can be pre-drilled upon request
- Straight edge option is slightly broken (approx. 0.5mm radius)
- Max panel/door size is 39" x 116" (1m x 3m)
- 18mm Parapan weighs 4.42 lbs / square foot

18mm Parapan is only available as cut to size, finished and polished doors, panels, or drawer fronts.

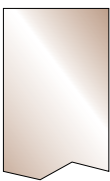

Edge Radius Options

Straight Edge	1mm Radius	2mm Radius	3mm Radius
			
— 18mm —	— 18mm —	— 18mm —	— 18mm —

Integrated Pulls

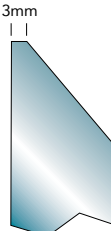
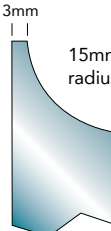
Straight	Curved
	
— 18mm —	— 18mm —

3mm
15mm radius



NORTHERN CONTOURS Cabinet Doors and Drawers

Northern Contours is the largest U.S. manufacturer of thermofoil cabinet doors and accessories. All orders are custom made and drop-shipped to the cabinet-maker within a 10 day lead time.

Find the perfect door style with Northern Contours' extensive selection of contemporary, transitional and traditional thermofoil cabinet doors and drawer fronts. 1-piece components are available in any of the standard thermofoil offerings including the latest in print technology with a variety of realistic woodgrains, textures, high gloss, and satin foils.

Go to www.northerncontours.com to see all available series, profiles, materials and finishes. The following are just a few examples.



Thermofoil Cabinet Doors and Drawer Fronts

Contemporary Series



Shaker Series





NORTHERN CONTOURS Cabinet Doors and Drawers cont.

LEVEL Doors and Drawer Fronts

For fresh modern designs, look no further than LEVEL, a series of flat laminated and edgebanded doors. Ultra high gloss acrylic, heavily textured melamine and the latest in linear and matte thermofoils along with 4 different edgebanding options offer you endless design combinations.

Go to www.northerncontours.com for a full materials listing.



3DL Thermofoil

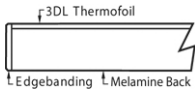

Acrylic and Wired

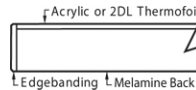

Impressions

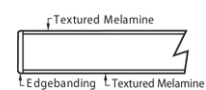

14 Thermofoil on the face with a melamine back. ABS/PVC edgebanding options include Matching, 3D Aluminum, or Steel Gloss.

Entire thermofoil line of accessories is available including frame doors, mouldings, valances, fillers, overlays, Norlam, PSA and cut to size panels in various thicknesses.

Ultra high gloss acrylic on the face with a melamine back. ABS edgebanding options include Matching, 3D Aluminum, Steel Gloss, or 2-Part (on White, Black, Ruby Red, Glass Green and Dark Grey).

Accessories are limited to overlays, cut to size panels, Norlam and PSA.

Textured melamine on the face and back. ABS edgebanding options include Matching, 3D Aluminum, or Steel Gloss.

Entire thermofoil line of accessories is available including frame doors, mouldings, valances, fillers, overlays, Norlam, PSA and cut to size panels in various thicknesses.

Edgebanding Options



2 Part



3D Aluminum



Matching

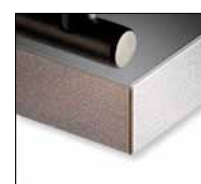

Steel Gloss

MacMURRAY PACIFIC
 568 7th St. San Francisco, CA 94103
 Email Form: orders@macmurraypacific.com
 Fax Form: (415) 552-5840

INQUIRY REQUEST: _____ PAGE _____ OF _____

ORDER DATE _____ CUST ID _____
 ORDERED BY _____ PO # _____
 PHONE _____ TAG TO _____
 FAX _____ PROJ NAME/QUOTE ID _____
 EMAIL _____

ONE DOOR STYLE PER ORDER FORM

BILL TO _____ SHIP TO _____ Commercial Residential
 ADDRESS _____ ADDRESS _____
 CITY _____ ST _____ ZIP _____ CITY _____ ST _____ ZIP _____

DOOR STYLE AND MATERIAL OPTIONS See Style Guide for detailed order instructions

Profile Name: _____ -OR- Custom Profile Name: _____
 Inside Profile: _____ Color: _____ Glazing: _____
 Outside Profile: _____ Backer Thickness: _____ Edgebanding: *LEVEL Products Only
 Style: _____ Backer: _____

*See Foil-Board Reference Chart for Complimentary availability

DOORS GRAIN DIRECTION: _____ FINGERPULLS: _____ FRAME BACKSIDE: _____
*Standard Grain Direction is Vertical *Fingerpull standard on top and bottom edges

HINGE BORING: _____ PAINT BACKS: _____

QTY	WIDTH	HEIGHT	NOTES (Frame, Mullion, etc)	QTY	WIDTH	HEIGHT	NOTES (Frame, Mullion, etc)
1				11			
2				12			
3				13			
4				14			
5				15			
6				16			
7				17			
8				18			
9				19			
10				20			

DRAWER FRONTS DRAWER FRONT STYLE: _____ FINGERPULLS: _____
 GRAIN DIRECTION: _____ *Standard Grain Direction is Horizontal on 3DL products Standard Grain Direction is Vertical on LEVEL products

QTY	WIDTH	HEIGHT	NOTES (drill for adjusters info)	QTY	WIDTH	HEIGHT	NOTES (drill for adjusters info)
1				7			
2				8			
3				9			
4				10			
5				11			
6				12			

ACCESSORIES W/ DIMENSIONS (Panels, Fillers, Overlay, etc. Cut-to-Size Panels will not have finished edges and are only available with LEVEL products. *Panels will have edgebanding on 1-3 sides for LEVEL products and unfinished edges for Standard 3DL products*) Please note grain direction where applicable.

QTY	WIDTH	HEIGHT	GRAIN	NOTES (Thickness, etc.)	QTY	WIDTH	HEIGHT	GRAIN	NOTES (Thickness, etc.)
1					4				
2					5				
3					6				

ACCESSORIES (Moulding, Rosettes, PSA, Norlam, Glass Clips, etc.) Please note grain direction where applicable.

QTY	ITEM DESCRIPTION	GRAIN	QTY	ITEM DESCRIPTION	GRAIN
1			4		
2			5		
3			6		

FLOATING SHELVES (Grain direction on Top, Bottom and Front Edge will always be Horizontal) Please note grain direction applicable to side edges only.
*Standard Height is 2", standard Depth is 10".

QTY	WIDTH	HEIGHT	DEPTH	GRAIN	Bracket	QTY	WIDTH	HEIGHT	DEPTH	GRAIN	Bracket
1						4					
2						5					
3						6					

PACKING INSTRUCTIONS - add'l charges apply Downstack Tag Box Liftgate Required Bundlewrap LTL Call for Apt Other _____

SHIPPING PREFERENCE NC Standard UPS Grnd UPS 3DA LTL Carrier UPS NDA Int'l UPS CPU (Cust Pick-Up) UPS 2DA

RECEIVING CAPABILITIES Loading Dock Pallet Jack Forklift

14

Notes: _____ Order Pc. Count: _____ 0

Signature: _____ Date: _____ © 2015-3 Northern Contours



High Gloss Custom Door & Drawer Fronts

LUXE is an advanced decorative panel with a high gloss finish on one face, while the back is a matching decorative matte melamine in the same design.

- 3/4" MDF Core
- High Gloss Polyester Front / Matte Back
- Two Edgebanding options (solid and bi-color)
- Separate edgebanding & boards available

View All Colors and Styles at
www.lioherenterprise.com/luxe/



This product is more durable than alternative products; highlighting its scratch-resistance, surface quality, high brightness as well as light stability towards colors.

These qualities make it well suited for vertical applications in kitchen, bathroom, office and home furniture.

The LUXE manufacturing process allows solid colors plus a wide range of designs, such as wood, marble, stone, fantasy etc.. This makes LUXE a highly versatile and decorative product.

Can be supplied in panels or in edged pieces. For this last option, LIOHER has PUR technology in order to offer its product the finish according to its quality.



Luxe Doors / Fronts **List**

Colors & Patterns	\$ 22.35 / sq ft.
(Sequenced)	\$ 28.16 / sq ft.



- See all colors and patterns next page



High Gloss Custom Door & Drawer Fronts Colors and Designs

Solids

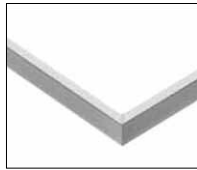

Blanco

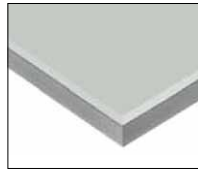

Gris 03

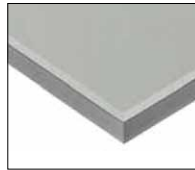

Gris Metallic

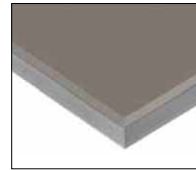

Basalto

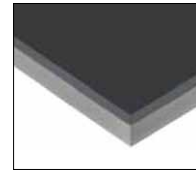

Antracita

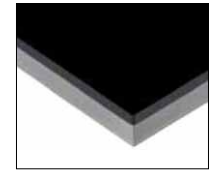

Negro

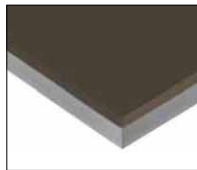

Lava

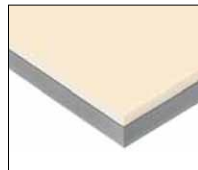

Magnolia

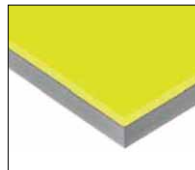

Pistacho

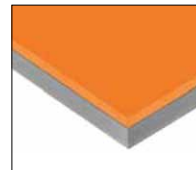

Naranja

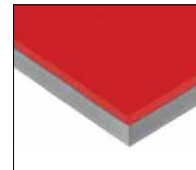

Rojo

Patterns



Cuzco Oro



Cuzco Cobre



Textil Plata

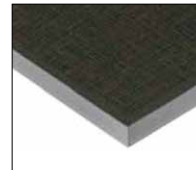

Textil Oro

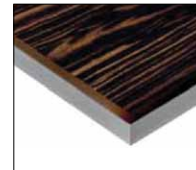

Guyana



Olmo



Roble Frapé



Olivo

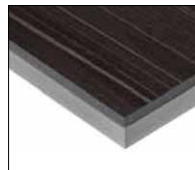

Euroline 03

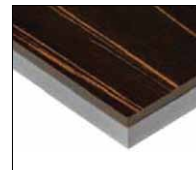

Euroline 02



Pino Malibú - 3 Tabaco

Laser Etched



Láser blanco

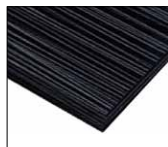

Láser negro

MetalDeco



Metaldeco
antracita SM



Metaldeco
basalto SM



Metaldeco
blanco SM

Pearl Effect



Blanco
Pearl Effect



Cobalto
Pearl Effect



Basalto
Pearl Effect

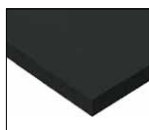

Antracita
Pearl Effect

Supermatt

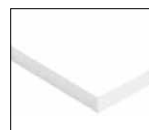

Supermatt
Blanco



Supermatt
Magnolia



Supermatt
Basalto



Supermatt
Antracita



Textured Melamine Panels



SYNCRON STRUCTURED PANELS give a naturalness and a high decorative texture to panels, door fronts and drawer fronts.

- Textured Melamine Front
- 3/4" MDF Core
- Includes matching edgebanding on cut to size pieces
- Cabinets, furniture, interior decorative projects
- Grain matching available at an extra cost

<u>Synchron Doors / Fronts</u>	<u>List</u>
Textured	\$ 11.22 / sq ft.
Sequenced	\$ 14.14 / sq ft.

Murrati



MU-001



MU-004

Jerez



OLM-002



OLM-003

Frappe



FPP-002



FPP-003

Rustik



RT-IDA-01



RT-IDA-03



RT-IDA-04

View All Colors and Styles at
www.lioherenterprise.com/synchron/

All Special Order

Images/Colors may not be exact representations.
Contact MacMurray Pacific to obtain samples.

See Order Form in back of catalog



ApplePly® by States Industries

WHITE MAPLE APPLE PLY DRAWER SIDES

Full Cartons Only

- Available in 4 popular heights (1/2" thickness)
- Bullnosed edge
- Prefinished to enhance Maple face veneer
- Clear, durable UV cured finish



8' Lengths
10 each/ctn.
Full Cartons only



Grooved

APPLE PLY QUALITY SELLS:

When people inspect a piece of furniture or cabinetry, the first thing they often do is open a drawer. Real Wood stands out; in a world of vinyl wraps, the demand for real wood products has never been greater. ApplePly sides take screws easily and accept the better quality slides. Clear UV finish on White Maple looks great, stays hard and resists water and household spills.



BULLNOSE EDGE

9-PLY MAPLE, 1/2" THICKNESS, 8' LENGTH

10 each/ctn. Full Cartons only

Code	Height	Description	List/ea
AP4M8G	4"	Bullnose, Grooved	\$ 27.95
AP6M8G	6"	" "	35.06
AP8M8G	8"	" "	45.02
AP10M8G	10"	" "	56.06

DRAWER BOTTOM STOCK - 3-PLY MAPLE

Finished on one side only. Full Cartons Only.

Code	Size	Ctn	List/pc
AP44M3	1/4" x 4' x 4'	7 pcs.	\$ 31.98

DRAWERS

DRAWERS: Pre-Assembled & Machined for Quadro, Grass, Enterprise and Salice Slides.



Materials: Solid Maple, Melamine, Maple 9-ply prefinished and unfinished, 7-ply prefinished Maple, MDF and more.

Construction: Dovetail, Butt Joint or Dowelled.

Customer Specs: Boxes guaranteed to size within 1/32" width, 1/16" height and 1/8" depth. All dimensions are O.D.

Fax Orders to: 415-552-8577
or Email: orders@macmurraypacific.com

See the following pages for Drawer Box Order Forms:

California Drawers (pg 1434)

Cimarron Drawers (pg 1437)

California Dovetail (pg 1435)

Drawer Box Specialties (pg 1436)

Western Dovetail (back of catalog)